

INSTALLATION GUIDE

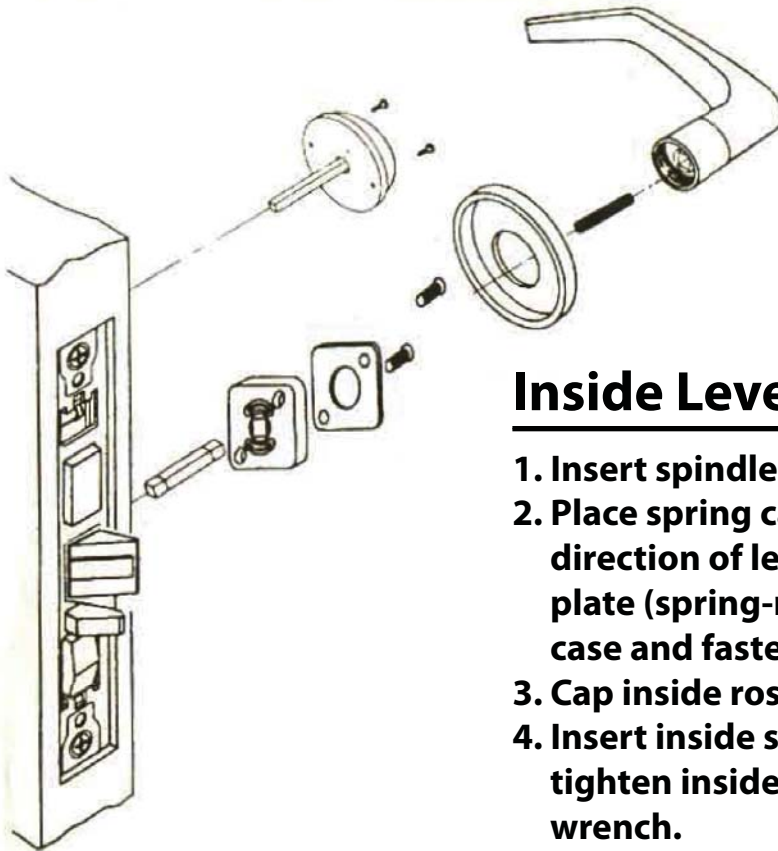

Inside Lever

1. Insert spindle into hub of lock case.
2. Place spring cage with arrows pointing in direction of lever rotation and mounting plate (spring-mount assembly) onto lock case and fasten into screws.
3. Cap inside rose over spring-mount assembly.
4. Insert inside spring into lever hole and tighten inside lever bushing with spanner wrench.
5. Insert turn piece assembly and fasten with screws.

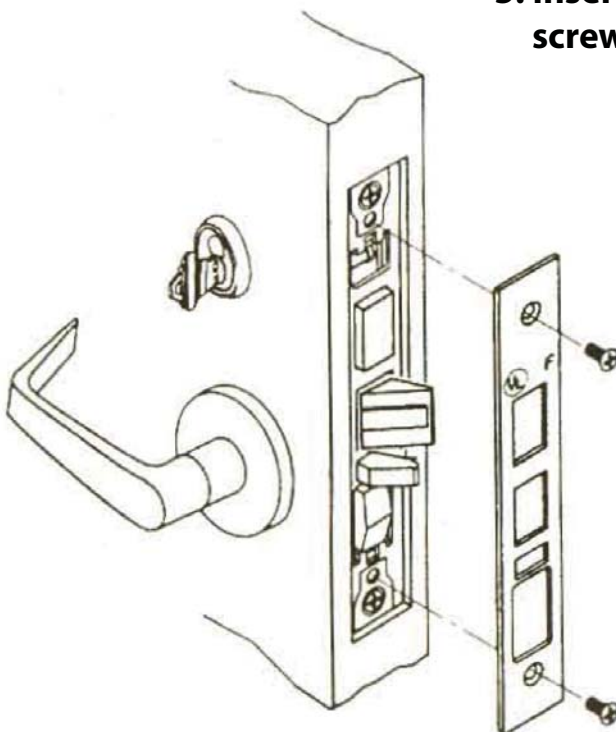

Front Plate

1. Install outside front plate onto lockcase front and then fasten with screws.

M SERIES Heavy Duty Mortise Lock

Door Preparation

1. Align door preparation template on edge of door with applicable lines. Check door preparation chart and mark only holes for lock function being installed.
2. Mortise door edge according to measurements of installation template and drill proper holes for trims.

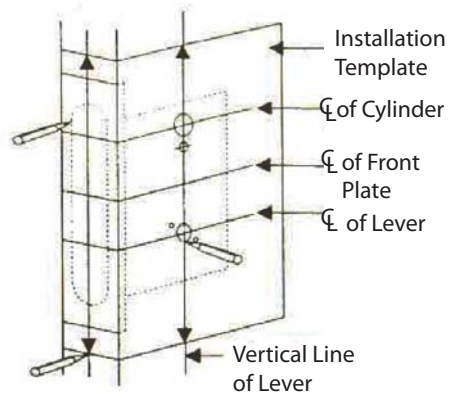

Strike preparation

1. Align strike template on jamb according to measurements of strike installation template. Bore 1" diameter holes into door edge, 1 1/8" deep. Recess 5/32" for fit of strike and box.

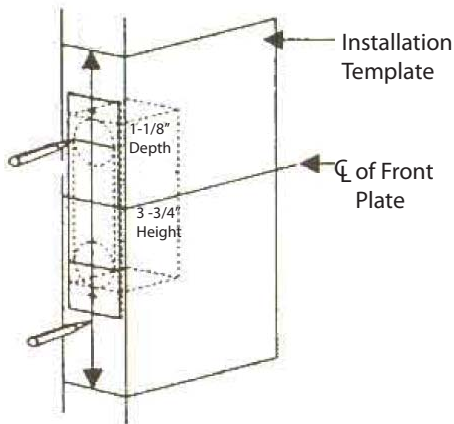

2. Mortise jamb according to measurement of installation template. Then fit strike and dust box into frame and secure into place with screws.

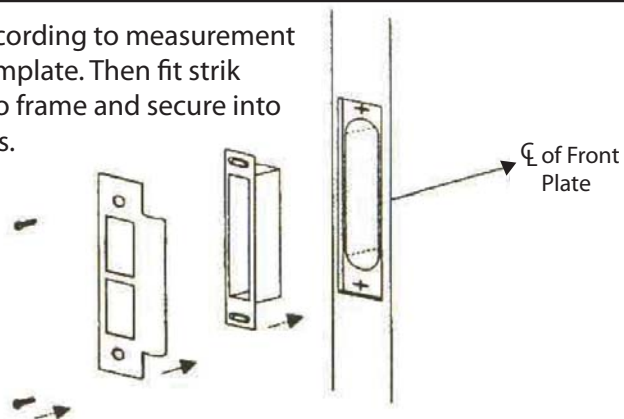

Lockcase Installation

1. Insert lockcase into mortise cut-out & fasten screws to door.

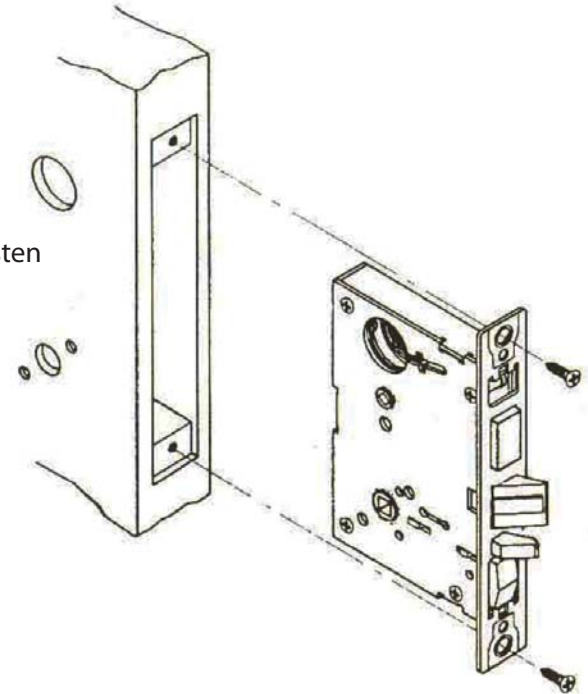

Outside lever

1. Place spring cage onto outside lever assembly with arrows pointing in direction of lever rotation. Insert spindle into hub of lock case.
2. Position outside lever assembly into post holes of lock case.

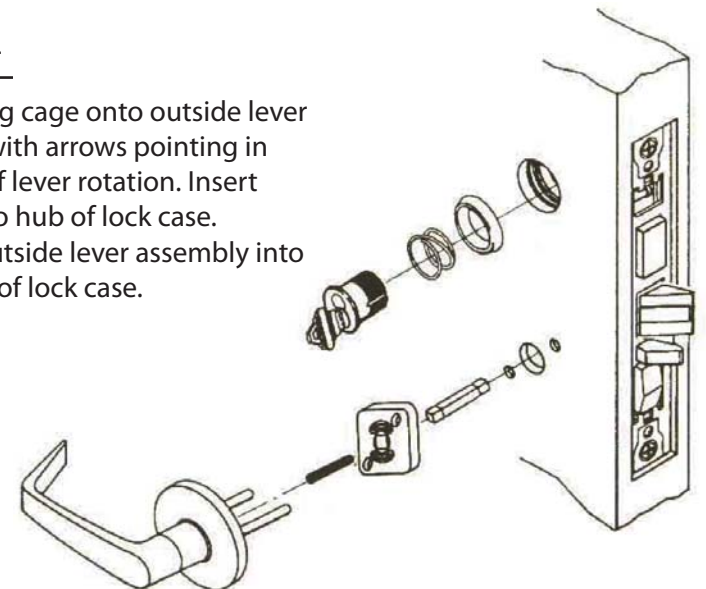

M SERIES Heavy Duty Mortise Lock

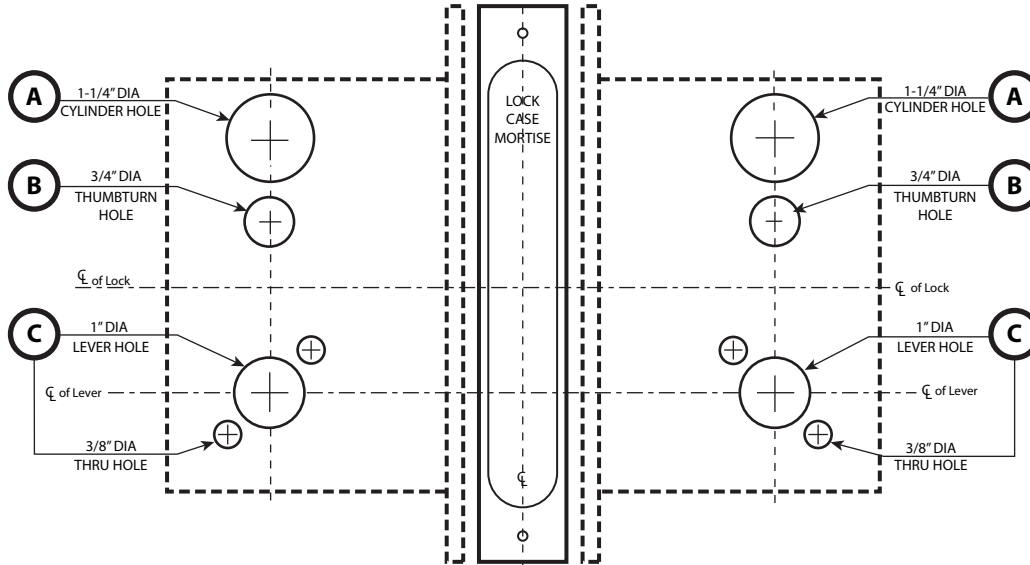

DOOR PREPARATION CHART						
SERIES	OUTSIDE			INSIDE		
	CYLINDER HOLE	THUMBTURN HOLE	LEVER HOLE	CYLINDER HOLE	THUMBTURN HOLE	LEVER HOLE
LOCK FUNCTION	A	B	C	A	B	C
NM8010			●			●
NM8040		●	●		●	●
NM8050	●		●			●
NM8056	●		●		●	●
NM8060	●		●	●		●
NM8070	●		●			●
NM8080	●		●			●
NM8170			●			
NM8453	●		●		●	●
NM8456	●		●		●	●
NM8466	●		●	●		●
NM8473	●		●		●	●
NM8485	●		●		●	●
M8460	●				●	
M8462	●			●		
M8463	●			●		
M8464	●					
M8465	●		●			●

STRIKE TEMPLATE

