

SG - Series

Instructions For Installing SG-Series Lever Handle Sets

NOTE : Accurate door preparation is essential for proper functioning of this lock. Follow template and instructions carefully.

The anti - sagging mechanism of handle in SG-series lever handle set has a patent pending in the U.S. and foreign countries.

Door and jamb preparation

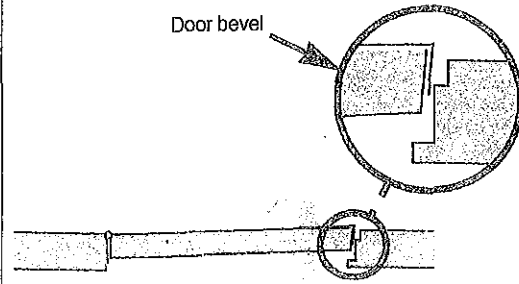
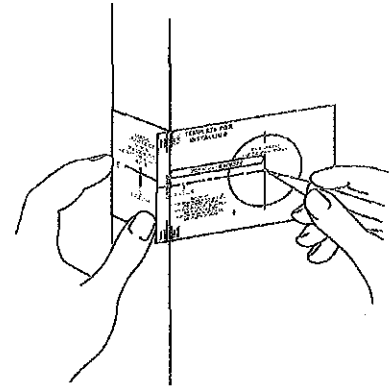

1. Mark door

- Check lock for proper backset and body before marking.
- Detach stub.
- Fold template at correct marking for door bevel (high or low bevel, or flat).
- Position template at correct height (recommended height for centerline is 38" (97cm) from floor).
- Mark center for 2 1/8" (54mm) hole.
- Use stub to mark center of door thickness.

2. Drill holes

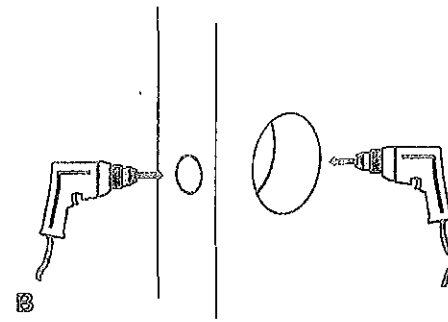

- Drill a 2 1/8" (54mm) hole through door (from both sides to avoid damaging door).
- Drill a 1" (25mm) or 7/8" (22mm) (depending on latch housing diameter) in door edge.

3. Install latch

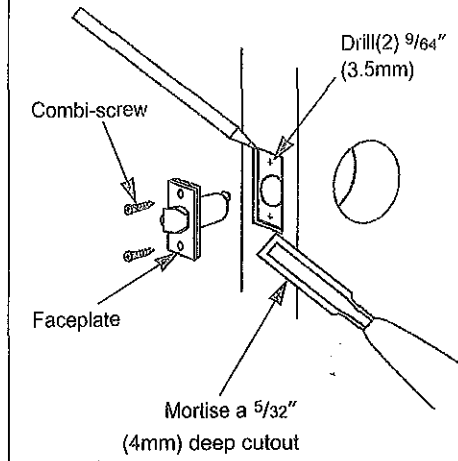

- Insert latch into hole. Trace around faceplate.
- Chisel out wood until faceplate fits flat with door edge.
- Drill two(2) 9/64" (3.5mm) holes and secure latch unit with combi-screws supplied.
- Fasten latch to door so that beveled side of latchbolt faces jamb.

4. Install strike

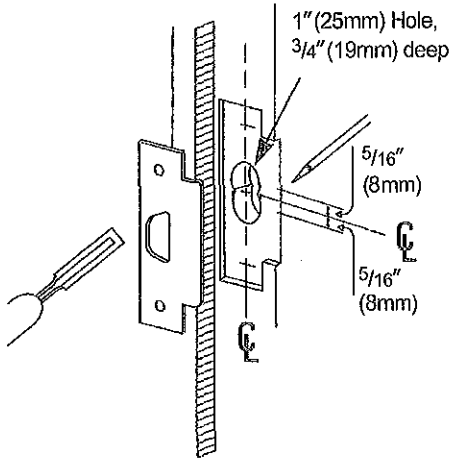

ASA Strike - Standard

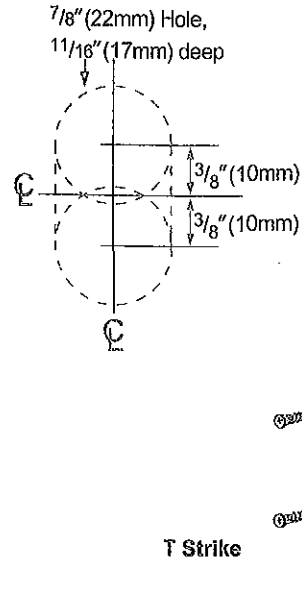

T Strike

- Mark vertical line and heightline on jamb exactly opposite center of latch hole.
- Drill two(2) 1" (25mm) holes, 3/4" (19mm) deep, 5/16" (8mm) above and below heightline.
- Use strike plate to pattern for cutout. Clean out hole and install strike.

- Mark vertical line and heightline on jamb exactly opposite center of latch hole.
- Drill two(2) 7/8" (22mm) holes, 1 1/16" (17mm) deep, into doorjamb as shown.
- Mortise a cutout for the strike. Use strike as a pattern for the mortise. (Strike should fit flush with the doorjamb.)

Lock Installation

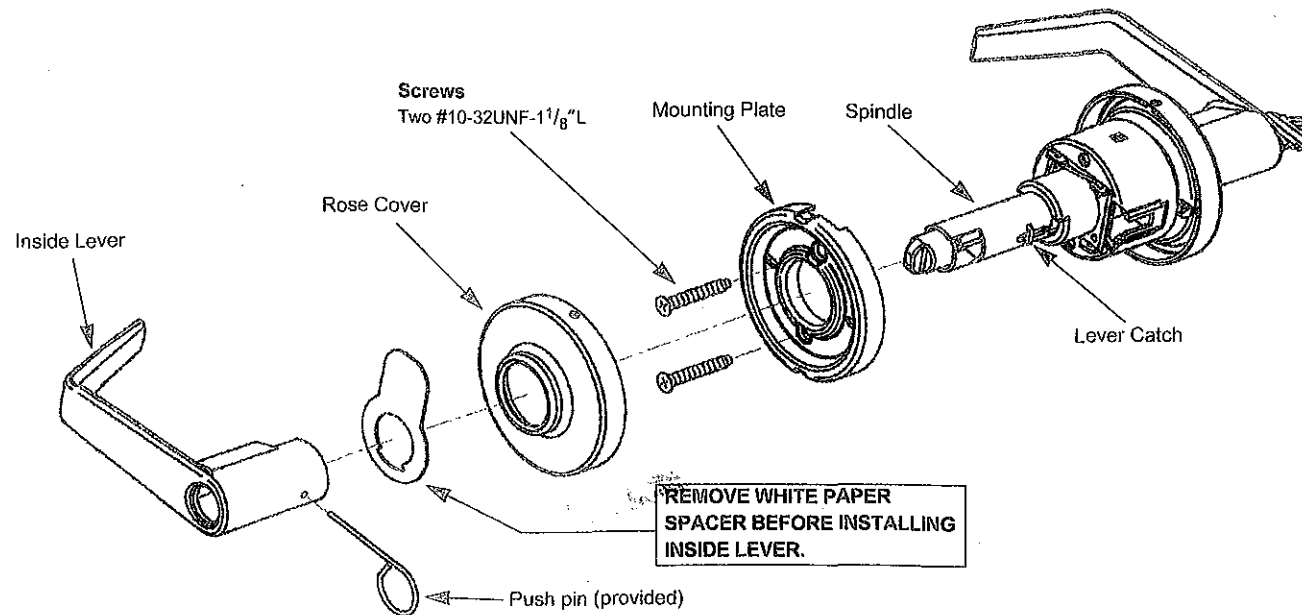

- Disassemble inside lever.
- Disassemble inside rose cover.
- Disassemble mounting plate.

5. Disassemble inside trim

INSTALLATION TEMPLATE

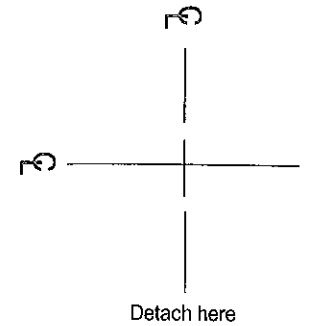

Mark center of door thickness for 1" (25mm) or 7/8" (22mm) hole, depending on latch housing diameter.

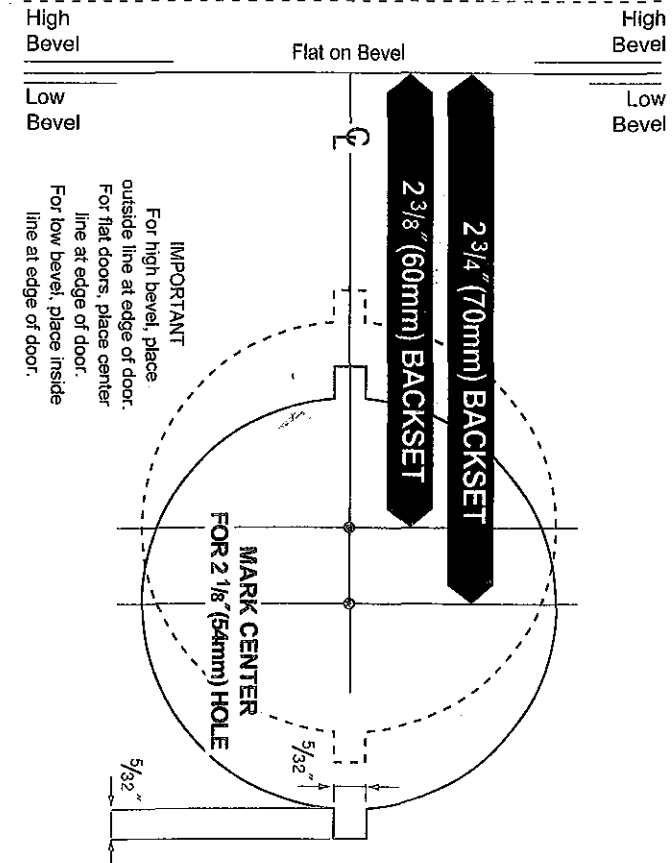

6. Adjust for door thickness

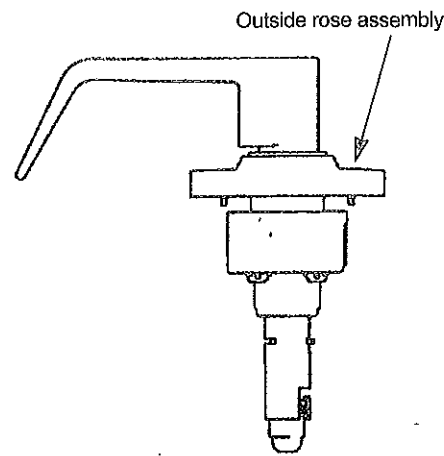

Lockset is factory preset for 1³/₄" (45mm) doors.

- A. It can be adjusted for door thickness range for 1³/₈" to 2"
- B. Rotate outside rose assembly until correct door thickness.

7. Install outside lock unit

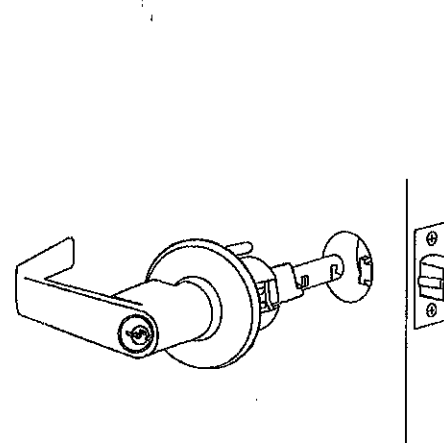

IMPORTANT : Place outside lock unit into position. Make sure that latch prongs engage chassis housing, and latch retractor engages latch bar.

- IMPORTANT :** This lock is factory preset for 1³/₄" (45mm) doors. See Step 6. to center chassis in door or to change adjustment of other door thicknesses

8. Install Mounting plate.

CAUTION : When using power screwdriver for installation, set to minimum torque setting.

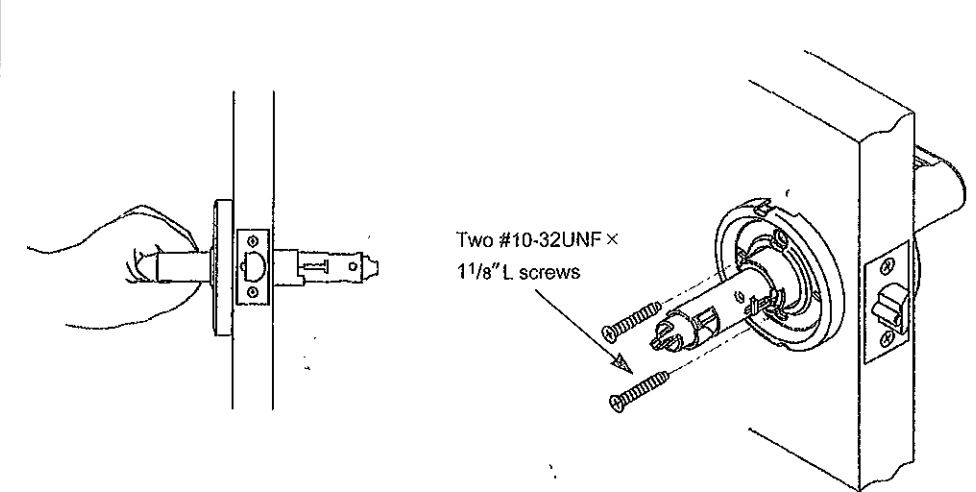

- A. Hold outside unit in place.
- B. Put mounting plate into position on chassis.
- C. Place mounting plate. Tighten it to lock body with two(2) #10 - 32UNF × 1¹/₈" L screws

9. Install inside rose cover

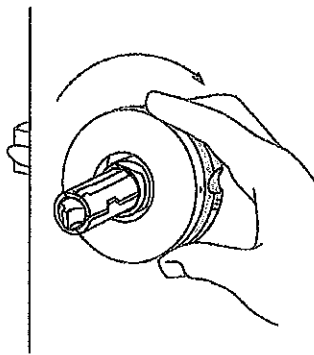

- A. Align dimples on rose with grooves in mounting plate.
- B. Place rose against door and rotate clockwise until dimples snap into slots next to the grooves.

10. Install inside lever

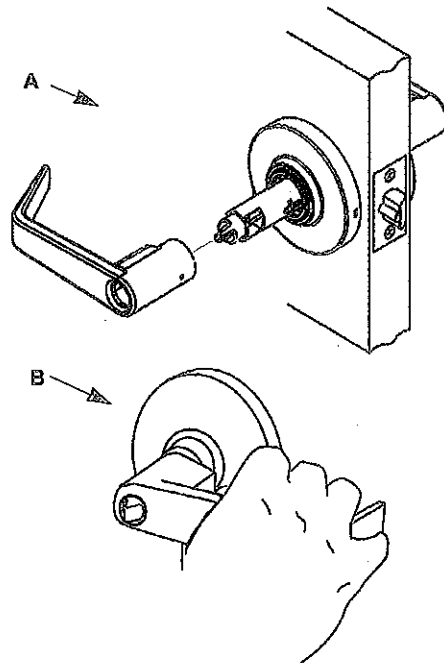

- A. Slide inside lever onto spindle. Push lever completely into place. (Pull on lever to make sure that catch is fully engaged.)
- B. Test operation of lock to make sure you have followed instructions correctly.

How to remove & reassemble outside lever

11. Remove outside lever

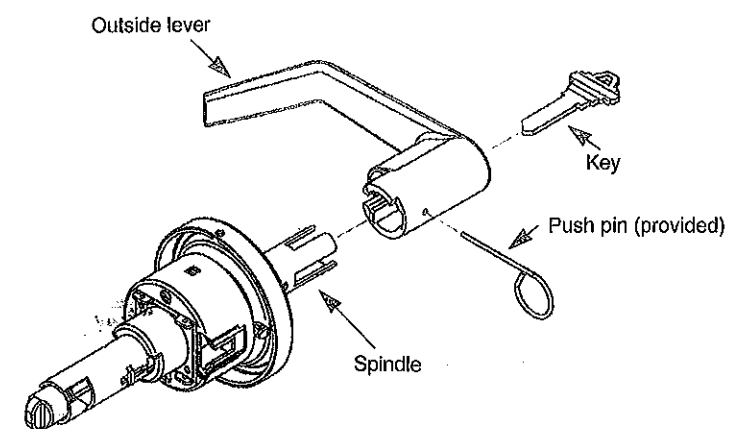

- A. Insert key into cylinder. Insert push pin (or similar tool) into hole in lever. Turn key one - quarter turn and push tool (push pin) to depress lever catch. Slide the lever from spindle.

12. Reassemble outside lever

Reverse Step 11 to reassemble levers.

- A. To reassemble. Put a cylinder and key in lever.
- B. Push cylinder further in until it engages retractor.
- C. Turn key 90° clockwise and hold a key.
- D. Depress lever catch and push lever (Not key) in until it clicks then release a key.

CAUTION FOR CLASSROOM FUNCTION

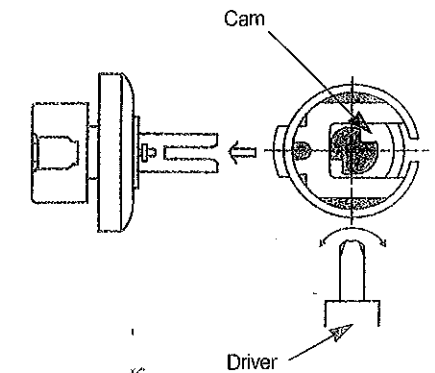

Make sure to turn cam anti - clockwise by driver as far as it will go before reassembling of cylinder to prevent mis-positioning of cam for classroom function.