

INSTALLATION INSTRUCTION

#4400 Series Panic Rim Device

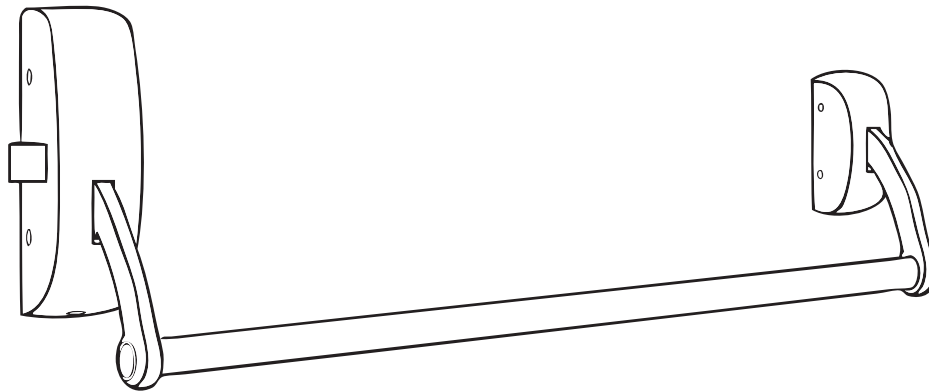

FUNCTION VARIATIONS

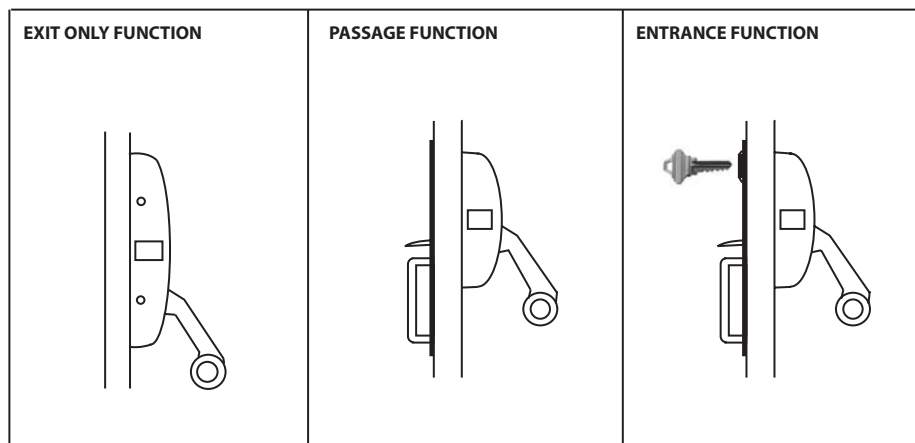
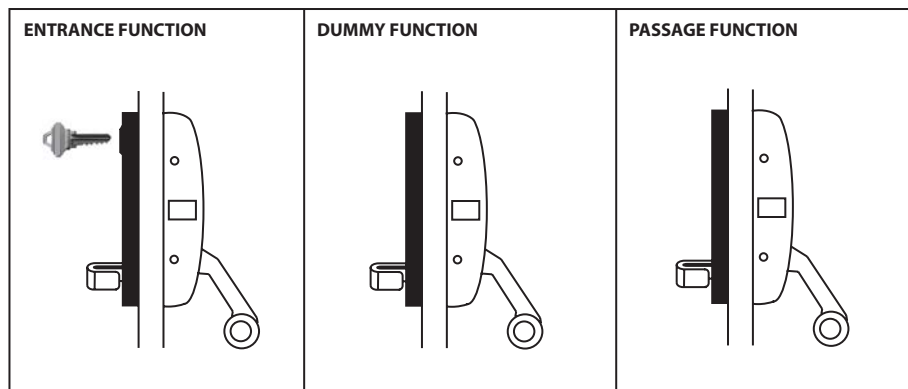

TYPES OF INSTALLATION

SINGLE DOOR

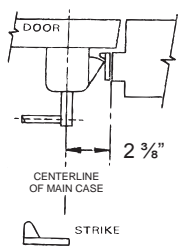

DOUBLE DOOR WITH MULLION

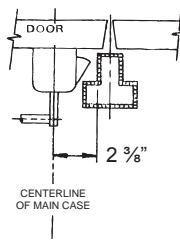

DOUBLE DOOR WITHOUT MULLION

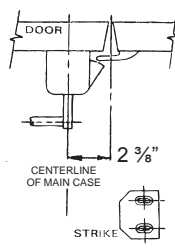

PARTS

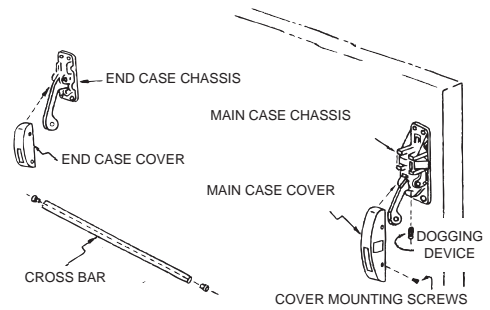

A

FIGURE A

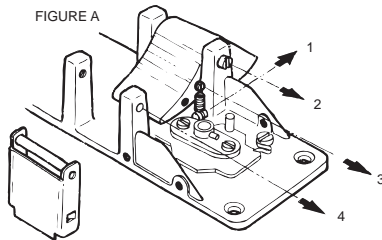
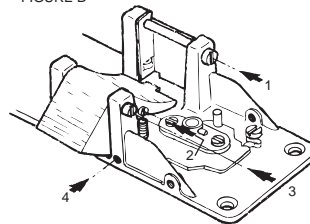

FIGURE B



1. REMOVE BOLTS, SCREWS AND SPRING - FIGURE A, STEPS 1 THROUGH 4
2. INTERCHANGE LATCH AND PLATE
3. REINSTALL BOLTS, SCREWS AND SPRING - FIGURE B, STEPS 1 THROUGH 4

F

MOUNT END CASE CHASSIS ON DOOR AND ATTACH END CASE COVER TO CHASSIS



G

ASSEMBLE AND SECURE CROSS BAR TO ARMS

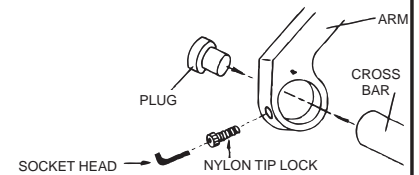

B

1. MARK VERTICAL CENTERLINE ON DOOR ACCORDING TO TYPE OF INSTALLATION AND STRIKE USED (SEE "TYPES OF INSTALLATION")

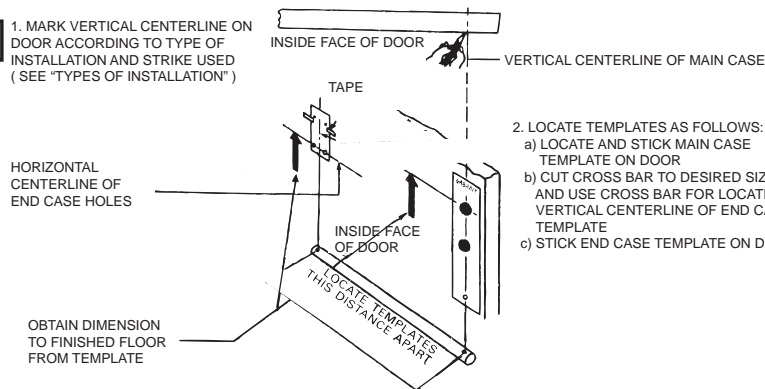

H

MOUNT STRIKE IN CENTRAL POSITION TO ALLOW FOR FUTURE ADJUSTMENTS

INSTRUCTION FOR APPLYING OUTSIDE RIM

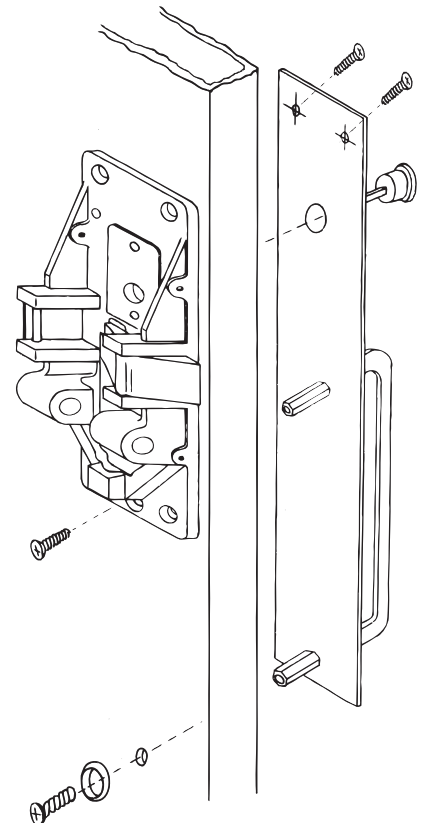

C

DRILL AND CUT HOLES AS DIRECTED ON TEMPLATE

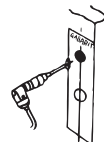

D

ATTACH OUTSIDE TRIM WHEN USED

REMOVE COVER FROM MAIN CASE CHASSIS AND MOUNT CHASSIS TO DOOR

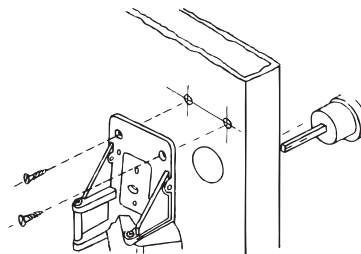

E

ATTACH MAIN CASE COVER TO CHASSIS WITH FOUR MOUNTING SCREWS

NOTE: TOP GRIP SCREW GOES THRU CHASSIS INTO GRIP

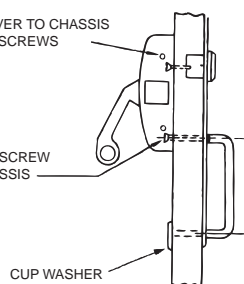

THUMB PIECE

