

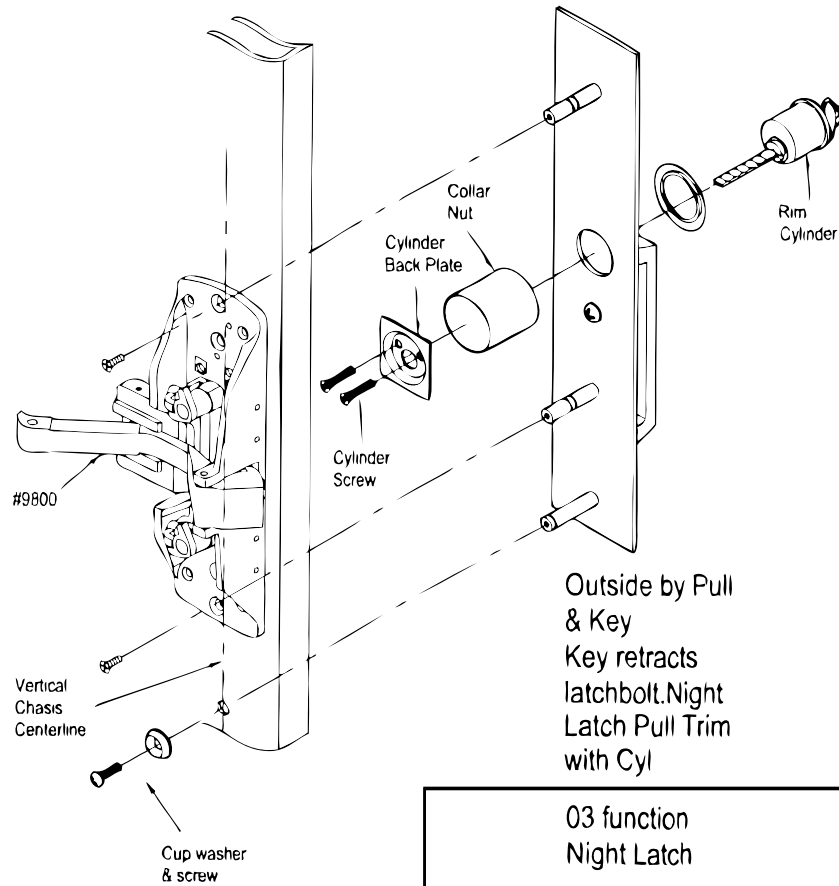

INSTALLATION INSTRUCTIONS FOR **CAL-ROYAL** OUTSIDE PULL TRIM For 9800/9860V Series Rim & Vertical Rod Exit Device



9800NL	9800DTP	9800EOP
<p>Outside by Pull & Key Key retracts latchbolt. Night Latch Pull Trim with Cyl</p>	<p>Outside by Pull only Pull when dogged</p>	<p>Outside by Cover Plate only</p>
<p>03 function Night Latch</p>	<p>02 function Pull</p>	<p>10 Function Cover Plate</p>
<p>ATTACH COLLAR, BACKPLATE AND RIM CYLINDER TO THE TRIM PLATE WITH THE (2) CYLINDER SCREWS ATTACH TO DOOR THRU BOLTING THE (2) SCREWS TO THE CHASSIS & (1) CUP WASHER & SCREW AT THE BOTTOM TO THE DOOR Covers 161 cut out</p>	<p>ATTACH TRIM TO DOOR THRU BOLTING THE (2) SCREWS TO THE CHASSIS & (1) CUP WASHER AND SCREWS AT THE BOTTOM TO THE DOOR Covers 161 cut out</p>	<p>ATTACH PLATE TO DOOR THRU BOLTING THE (2) SCREWS TO THE CHASSIS COVERS 161 CUT OUT</p>