

# (ELR) Electric Latch Retraction



Our motor driven electrified latch pullback exit device allows for remote keyless access control in high occupancy / high traffic conditions where exit devices are required. Common applications include conditions such as hospitals, airports, schools, churches and they are commonly specified in applications that require automatic door openers. The device may be continuously energized allowing for a push / pull condition if desired.

## Features:

- Available on 9800 Series, including rim, vertical rod, concealed vertical rod, mortise exit device, fire and non fire-rated devices
- MM4 Smart Module: On board diagnostics with audible feedback for adjustment and power issues
- “PTS” (Push to Set Technology): 5 second electronic adjustment for easy post installation adjustment
- Electric dogging rated for continuous duty - Auto retraction if dogged push pad is pulled from position
- Low Current Draw - Field switchable to “High Torque” mode
- Up to 300’ wire run with (2) 18ga wire - Long wire runs provides installer with convenience of placing the locking device power supply in a centralized location; i.e. the same closet as the access panel
- 8’ cable with Quick Connect for MM4 module to easily connect to power supply lead
- 3-year “No Hassle” warranty

## Specifications:

- Voltage – 24 to 28V DC
- System protection – unit shutdown when voltage exceeds 28V DC
- Average In-rush Current – 900mA; Average Hold Current - 215mA
- PTS adjustment – approx. ¼”
- Wire run: 300’ with 18ga wire

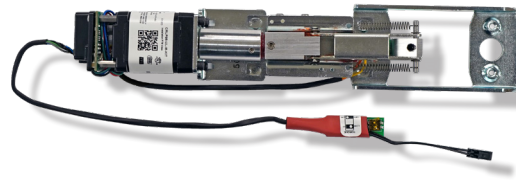

**INSTALLED ON THE EXIT  
DEVICE: USE FLR2298 ADD**

**FOR FIELD INSTALLATION  
USE FLR2298 KIT**

## To Order:

- **Must Specify: Exit Device item #** and **FLR2298 ADD** as two separate line items.  
For Example: A9800EO36 US32D with ELR option, order “**A9800EO36 US32D**”, and “**FLR2298 ADD**” as two line items.
- **\*Use FLR2298 KIT if ordered separately.**
- **Optional Switch** (RX or LX) is also available and should be added as a **3<sup>rd</sup> line item** as needed.

**Note:** When using electrified hinge, you must use prefix ELELRn + hinge item code, where “n” is equal to number of wires. For example: ELELR4 + BB31.

**MUST USE CRP POWER SUPPLIES TO  
HONOR WARRANTY (see pages 97-98)**

# Signal Switch RX and LX

**RX** (request to exit) signal switch is used to signal the use of an opening from the push side. When the push pad is depressed, the switch is activated. These devices are equipped with an internal SPDT (single pole double throw) switch that monitors the touch bar.

**LX** (latch bolt monitoring) signal switch monitors both egress and access of an opening. When the latch bolt is retracted, the switch is activated. These devices are equipped with an internal SPDT (single pole double throw) switch that monitors the latch bolt position.

**LX** and **RX** switches can be combined.

**LX, RX** switches can be used in combination with ELR (electric latch retraction) option.

## Specifications

**RX** or **LX**.....Switch rated 0.5 amps @ 24V AC / DC resistive  
Low current **RX** or **LX**.Switch rated 0.5 amps @ 24V AC / DC resistive

## for Factory Installed. To Order, Specify:

- RX22/98**.....Request to Exit switch for field installation
- LX9800**.....Latch bolt Monitoring switch for field installation
- LXRX9800**.....Latch bolt Monitoring / Request to Exit Combination

# Trim Selection

## ESCUTCHEON LEVER DESIGN

### CONSTRUCTION

- Free-wheeling clutch mechanism.
- Grade 1, thru-bolted design. Reversible design
- Hardened steel heavy duty tailpiece.
- Available for rim and concealed vertical rod exit devices

### DOOR THICKNESS

Standard 1 3/4"

### ESCUTCHEON DIMENSIONS

1 13/16" width X 8" length

Lever length: 5"

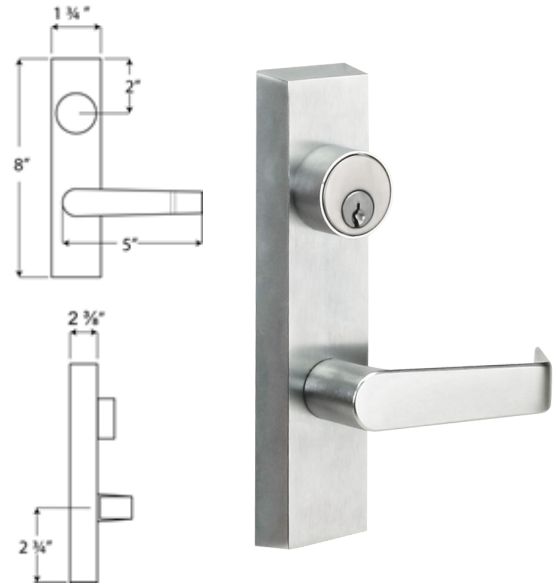

- GLSRIM9800**
- GLSCVR9800**
- ⌘ **ICGLSRIM9800**
- ⌘ **ICSCGLSRIM9800**
- ⌘ **ICGLSCVR9800**
- ⌘ **ICSCGLSCVR9800**

### ENTRANCE

Clutch free-wheeling Entrance, key locks or unlocks escutcheon trim ANSI Function (08) Operates as classroom function  
CVR is used for Concealed Vertical Rod Exit Device  
RIM is used for Rim Type Exit Device

- GLSRIM9805**
- GLSCVR9805**
- ⌘ **ICGLSRIM9805**
- ⌘ **ICSCGLSRIM9805**
- ⌘ **ICGLSCVR9805**
- ⌘ **ICSCGLSCVR9805**

### STOREROOM

Clutch free-wheeling Storeroom, key unlocks lever, lever retracts latch bolt, otherwise always locked.  
ANSI Function (09)  
CVR is used for Concealed Vertical Rod Exit Device  
RIM is used for Rim Type Exit Device

- GLSRIM9830**
- GLSCVR9830**

### PASSAGE

Trim always operable and free  
ANSI Function (14)  
CVR is used for Concealed Vertical Rod Exit Device  
RIM is used for Rim Type Exit Device

- GLSRIM9840**
- GLSCVR9840**

### DUMMY

Dummy Escutcheon trim ANSI Function (02)  
CVR is used for Concealed Vertical Rod Exit Device  
RIM is used for Rim Type Exit Device

**IMPORTANT: GLS9800 and GLSCVR9800 Trims can be used with GLS7700 and GLSCVR7700 Exit Devices**

### NOTES:

- AT, RL, TUB lever design is available upon request.
- **ELECTRIFICATION NOT AVAILABLE FOR TRIM**
- Electrical Latch Retraction (ELR), Request to Exit (RX) and Latchbolt Monitoring (LX) available for Exit Device only.
- Anti-Microbial Coating available in US26D Only. Use part # "ANTB-TRIM" when ordering.

**KEYWAY:** 6-Pin solid brass "C" keyway Rim Cylinder standard. Optional: Schlage E, Schlage C-K, Russwin D1-2-3-4, Corbin 59/60, Sargent LA-LB-LC, Falcon/Weiser E, Arrow A, Yale 8, Yale GA and Kwikset. Can also accept Medeco, Assa, Kaba and **Cal-Royal HSK** High Secity Cylinders.

⌘ **(IC) INTERCHANGEABLE CORE:** Interchangeable Core locks will accept compatible 6 or 7-Pin cores with BEST, FALCON and ARROW

⌘ **(ICSC) INTERCHANGEABLE CORE:** Indicates function available with **Schlage Full Size Format** Interchangeable Core. Corbin, Sargent and Yale format also available.

# Trim Selection

PULL DESIGN - FOR GLS9800 RIM EXIT DEVICE ONLY



**98GLSNL**  
**⚙️ IC98GLSNL**  
**⚙️ ICSC98GLSNL**

Outside by pull and key.  
 Key retracts latch bolt.  
 ANSI Function (03)  
**(SPECIFY HANDING)**



**98GLSUP**

Outside by pull only.  
 Pull when dogged.  
 ANSI Function (02)  
**(NON-HANDED)**

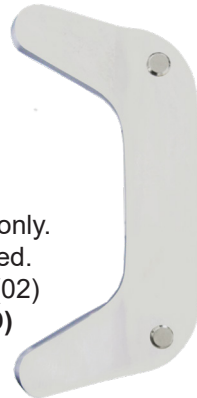

**GLSRIMEOP**

Outside cover plate  
 only.  
**ANSI Function (01)**

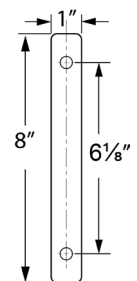
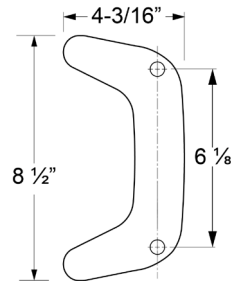
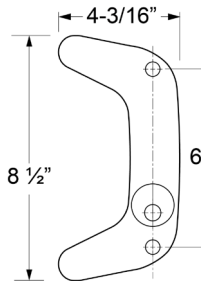

**KEYWAY**

Standard 6-Pin solid brass "C" keyway Rim Cylinder included.

**FINISHES**

Architectural plated finishes.

**IMPORTANT: GLS9800 and GLSCVR9800 Trims can be used with GLS7700 & GLSCVR7700 Exit Devices**

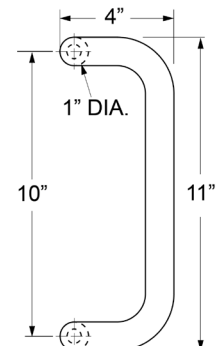

**98GLSCYL-1**

**⚙️ IC98GLSCYL-1**  
**⚙️ ICSC98GLSCYL-1**

**OFSTPUL-10**  
**(REVERSIBLE)**

**KEYWAY:** 6-Pin solid brass "C" keyway Rim Cylinder standard. Optional: Schlage E, Schlage C-K, Russwin D1-2-3-4, Corbin 59/60, Sargent LA-LB-LC, Falcon/Weiser E, Arrow A, Yale 8, Yale GA and Kwikset. Can also accept Medeco, Assa, Kaba and **Cal-Royal HSK** High Security Cylinders.

**⚙️ (IC) INTERCHANGEABLE CORE:** Interchangeable Core locks will accept compatible 6 or 7-Pin cores with BEST, FALCON and ARROW

**⚙️ (ICSC) INTERCHANGEABLE CORE:** Indicates function available with Schlage Full Size Format Interchangeable Core. Corbin, Sargent and Yale format also available.

# Strikes & Accessories



## Strikes for use with A9860V Vertical Rod Exit Device All strikes are black nylon coated

**221**  
Standard for A9860V. Applied to surface of floor or to a flat threshold. Standard packaging.

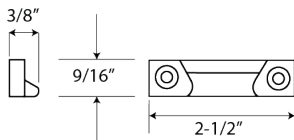

**227**  
Applied to surface of stop. No mortise required. Standard packaging.

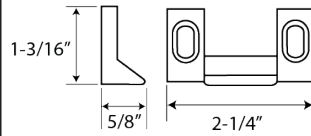

**233**  
Bottom stike. Alternate bottom strike. Flush mounting, stainless steel. Furnished with expansion shields. Requires mortise on the floor.

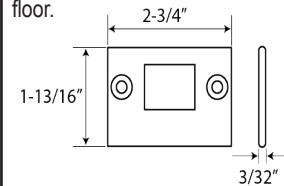

## Strikes for use with A9800 Rim Type Exit Device

**239**  
For A9800 surface applied. Standard packaging.

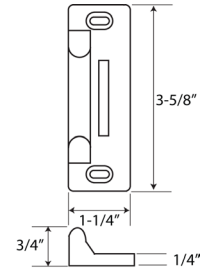

## RIM238 Strike for 2 3/8" Backset Application

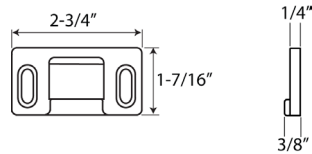

## Strikes for FMCVR9800, MCVR9800, WCVR9800, FWCVR9800, GLSCVR9800 Fire and Non-Fire Exit Devices

### 260 TOP STRIKE

### 265 BOTTOM STRIKE

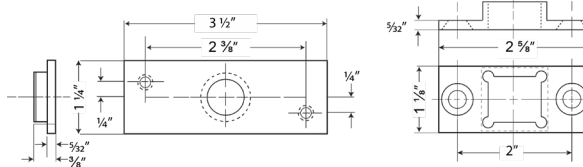

## Strike for use with AF9800 Rim Type Fire Exit Device

**245**  
For AF9800 surface applied. Standard packaging.

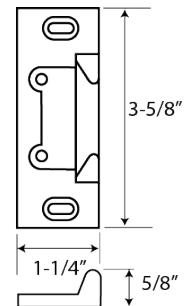

## Strikes for use with AF9860V Vertical Rod Fire Exit Device

**245**  
For AF9860V surface applied. Standard packaging.

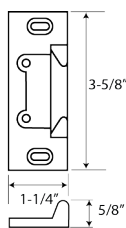

## Strikes for use with GLS9800 Narrow Stile Exit Device

**246**  
Used on frames with blade stop or integral stop. Surfaced applied or mortised. Standard packaging.

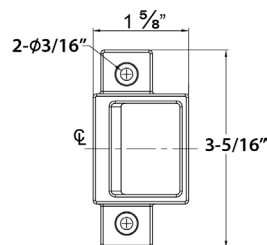

**247**  
Applied to surface of stop. No mortise required.

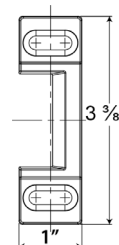

## ADA Roller Strike for A9800, AF9800, A9860V, and AF9860V Fire and Non-Fire Exit Devices

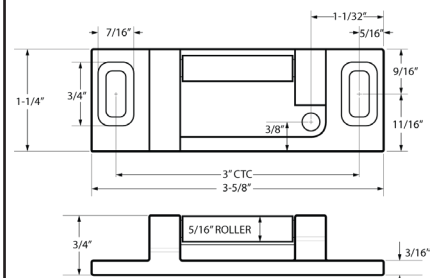

**945 (NON-FIRE RATED)**  
**945F (FIRE RATED)**

**233**  
Bottom strike for AF9860V. Flush mounting stainless steel. Furnished with expansion shields. Requires mortise in the floor. Standard packaging

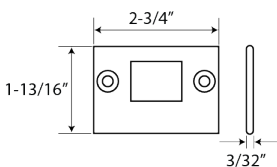

## Overlapping Strikes

**N251**  
Surface applied. Used on inactive leaf for device on active leaf of pair of doors without mullion.

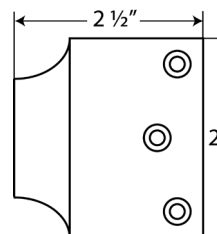

# Accessories



<b>LFF</b>	
<p>Lock front filler</p>	
<b>SF</b>	
<p>Strike filler</p>	
<b>GLASS BEAD SHIM KITS</b>	
<p><b>801</b> – For rim type, 1/8" thick  <b>806</b> – For vertical type, 1/8" thick  <b>812</b> – For fire rated type, 1/8" thick</p>	
<b>CYLINDER DOGGING KITS</b>	
<p><b>TO ORDER:</b> Prefix "CD" before PART #.            Available for all 9800 Series devices except fire exit hardware.            Cylinder dogging with mortise cylinder is located on the mounting insert lock bolt in retracted position.</p> <p><b>KIT ONLY:</b> Use PART # 36CD9800 for 36" and 48CD9800 for 48" devices. Specify finish.</p> <p><b>NOTE:</b> Use PART # 48CD9800 for 36" GLS Narrow Stile Rim and CVR Non-Fire Exit Devices.</p>	<p style="text-align: center;"><b>CYLINDER DOGGING KIT</b></p> <ul style="list-style-type: none"> <li>● <b>(IC) INTERCHANGEABLE CORE:</b> Interchangeable Core locks will accept compatible 6 or 7-Pin cores with BEST, FALCON and ARROW</li> <li>● <b>(ICSC) INTERCHANGEABLE CORE:</b> Indicates function available with Schlage Full Size Format Interchangeable Core. Corbin, Sargent and Yale format also available.</li> </ul>