

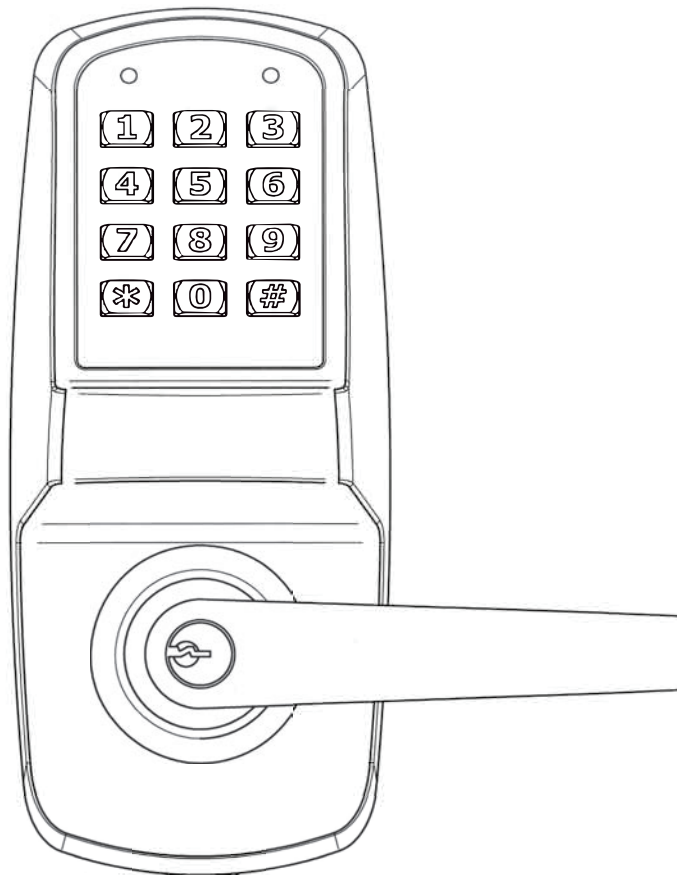

# CR8000 Series

Stand-alone Pushbutton Access Lock  
ANSI/BHMA Grade 1

## Installation and Programming Instructions



Take the time to read through this guide to familiarize with the features and operation of the lock, and its quick and easy programming procedures.

***Save this PROGRAMMING INSTRUCTIONS for future reference.***

■ **Note:** Improper installation may result in damage to the lock and void warranty.



# INSTALLATION GUIDE

## TABLE OF CONTENTS

Warnings .....	3
Introduction .....	3
Specifications .....	4
Parts Breakdown .....	4~5
Tools for Installation .....	5
Installation Instructions	
Verify Hand and Bevel of Door .....	6
Door & Frame Preparation .....	6~7
Prepare Lock for Installation .....	8~9
Lock Installation .....	10~11
Test Lock Operation .....	12
Hardware Troubleshooting .....	12

## WARNINGS

**Warning:** *Changes or modifications to this unit not expressly approved by the party responsible for compliance could void the user's authority to operate the equipment.*

- Change your PIN code regularly to ensure the security of your PIN code.
- Weather resistant, but recommend that the lock be protected from very wet conditions.
- Do not exert excessive force or use sharp instruments to press the buttons on the lock.
- Ensure that the door is properly locked when going outside.
- Ensure the batteries have been installed according to the correct polarity.
- When the battery life expiration warning sounds, replace all batteries with new batteries within one week.
- Do not mix old batteries with new batteries.
- Do not hang on the lock or pull on it with excessive force.
- Use a soft, dry cloth to clean the lock and avoid cleaning with water, benzene or alcohol, etc.

## INTRODUCTION

Congratulations on the purchase of your Pushbutton Access Cylindrical Lock! Your lock combines a touch-sensitive keypad with a robust cylindrical lock. You can program up to 100 users to open the lock with unique PIN codes. This product is engineered for quick & easy installation and fits into the standard ANSI/BHMA A156.115 cylindrical locks with lever door prep with additional two (1" and 3/8") hole and 11 screws including latchbolt and strike. This product is operated by four (4) "AA" alkaline batteries.

## SPECIFICATIONS

- Latch brass - 1/2"(13mm) throw standard
- Deadlocking latch
- Outside lever controlled by keypad, or key retracts latch
- Inside lever retracts latch
- Locks furnished for 1-3/8"(35mm) to 1-3/4"(45mm) doors.
- U.L. Listed

## PARTS BREAKDOWN

Confirming the Box Contents The following items should be included in the box:

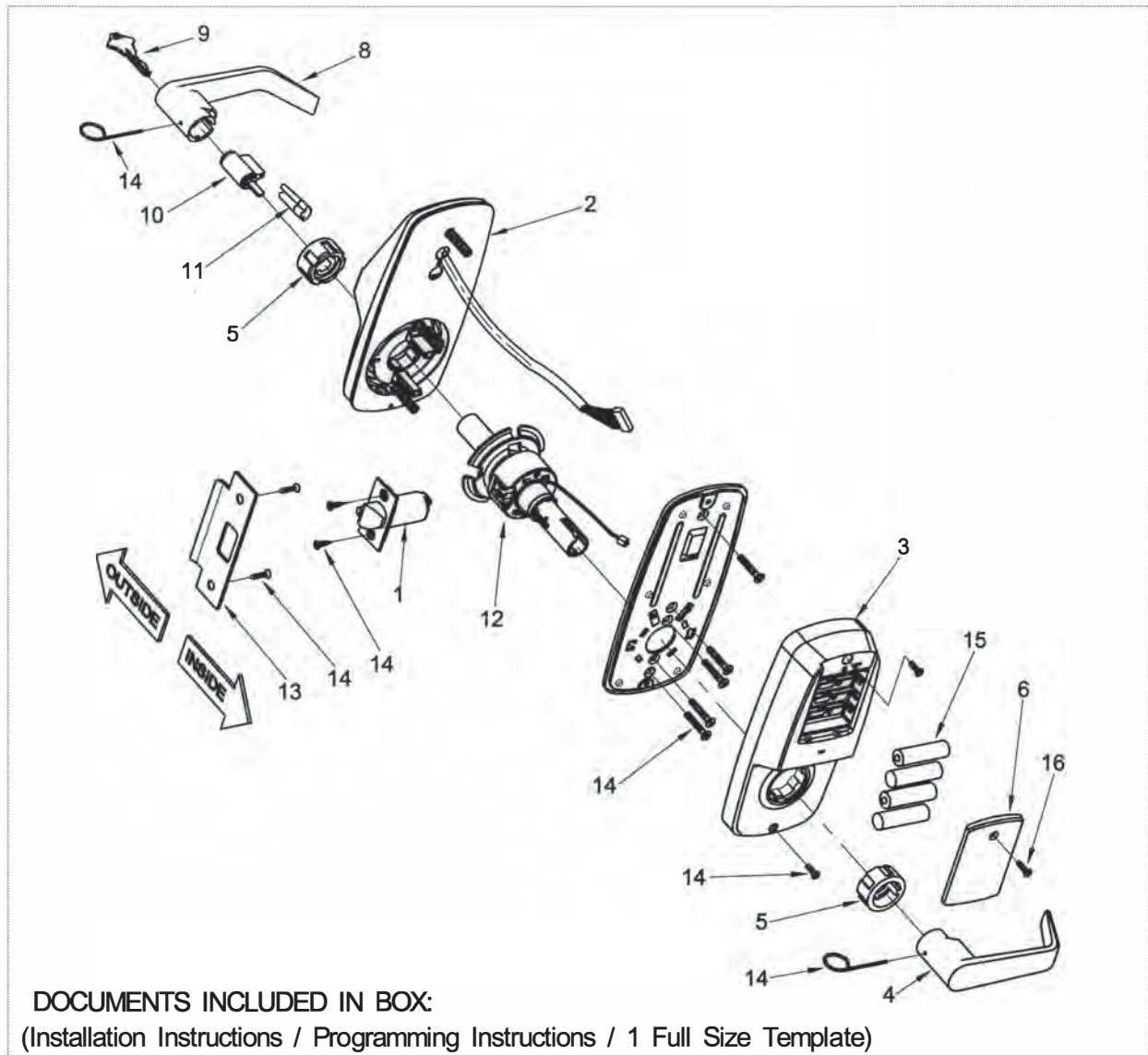

## PARTS BREAKDOWN (Continued)

ITEM NO.	DESCRIPTION	QTY.
1	Latch (2-3/4"(70mm) Backset (Standard))	1
2	Outside Assembly	1
3	Inside Escutcheon	1
4	Inside Lever	1
5	Spacer Bushing	2
6	Battery Cover	1
7	Mounting Plate Assembly	1
8	Outside Lever	1
9	Key (Provided with Cylinder)	2
10	Cylinder	1
11	Cylinder Retainer	2
12	Lock Body	1
13	Strike	1
14	Screw Pack <ul style="list-style-type: none"> <li>▪ (2) 12-24×3/4"(19mm) FL HD Combination Screws for Strike</li> <li>▪ (2) 8-32×3/4"(19mm) FL HD Combination Screws for Latch</li> <li>▪ (5) 10-32×1-1/5"(30mm) FL HD Machine Screws for Mounting Plate</li> <li>▪ (2) M5.0xP0.8-3/4"(19mm) FL HD Machine Screws for Inside Escutcheon</li> <li>▪ (1) Lever removal tool</li> </ul>	1
15	AA Alkaline Batteries	4
16	Battery Cover Screw	1

## TOOLS FOR INSTALLATION

### Door Prep

- Pencil
- Center punch
- Hammer
- Wood chisel
- Drill with 3/8" or 1/2" chuck
- 2-1/8"(54mm) hole saw
- 1"(25mm) boring bit
- 3/8"(9.5mm) & 7/64"(2.5mm) drill bit

### Lock Installation

- #2 phillips screw driver
- Lever removal tool (supplied)

## INSTALLATION INSTRUCTIONS

### Step #1 Verify Hand and Bevel of Door

Stand on outside/locked side of the door when determining the door hand.

**Note** *This lock is non-handed and the lever can be flipped around to the desirable hand.*



Left Hand  
Hinges Left  
Open Inward  
"LH"

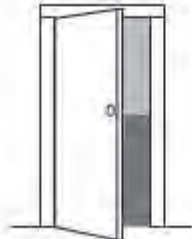

Left Hand  
Reverse Bevel  
Hinges Left  
Open Outward  
"LHRB"



Right Hand  
Hinges Right  
Open Inward  
"RH"



Right Hand  
Reverse Bevel  
Hinges Right  
Open Outward  
"RHRB"

### Step #2 Door & Frame Preparation

**IMPORTANT:** *The accuracy of the door preparation is critical for the proper functioning and security of this lever handle lock. Misalignment can cause premature wear and tear and a lessening of security.*

#### For uncut Doors and Frames

##### A. Mark Centerline

Draw a horizontal centerline for the lever (the centerline for the lock body hole) on the edge and on both sides of the door at the desired height above the finished floor.

**Note 1:** *The recommended height from the floor to the lock is 38"(97cm).*

**Note 2:** *If strike mortice already exist in frame locate the horizontal centerline of the lock using strike mortice as reference.*

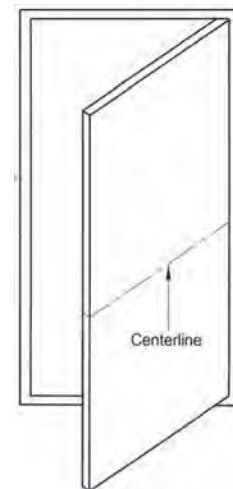

## B. Position Template and Mark Drill Points

Be sure to verify backset before marking and drilling door.

1. Fold and Place template on high edge of door at the horizontal centerline.
2. Mark centers of holes at proper backset. For beveled and square edge doors mark both sides of the door.

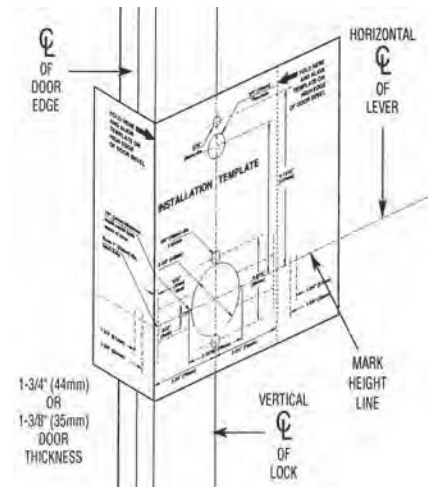

## C. Drill Holes and Mortise for Latch face

1. Drill 2-1/8"(54mm) diameter hole through the door. Cut notches as shown on template.
2. Drill 1"(25mm) diameter hole through the door according to template.
3. Drill 1"(25mm) diameter hole in edge of door. Mortise for latch front 5/32"(4mm) deep 1-1/8"(29mm) wide × 2-1/4"(57mm) high.
4. Drill three (3) 3/8"(9.5mm) diameter holes through door.
5. Drill the holes for the screws used to install the latch. 7/64"(2.5mm)

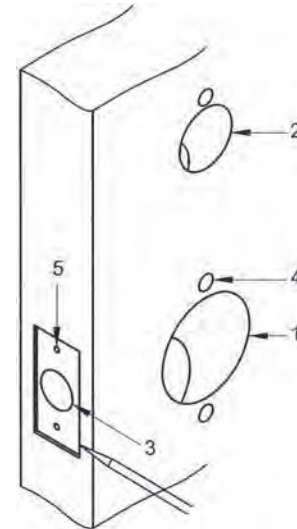

**Note:** To avoid splintering wood doors drill holes from both sides of the door.

## D. Prepare and Install Strike (Wood Frames Only)

1. Mark vertical line and centerline on frame exactly opposite center of latch hole.
2. Drill two (2) 1"(25mm) holes 5/16"(8mm) above and below centerline.
3. Mortise a cutout for strike. Use strike as a pattern for mortise. (Strike should fit flush with frame.)
4. Drill the holes for the screws used to install the strike. 7/64"(2.5mm)

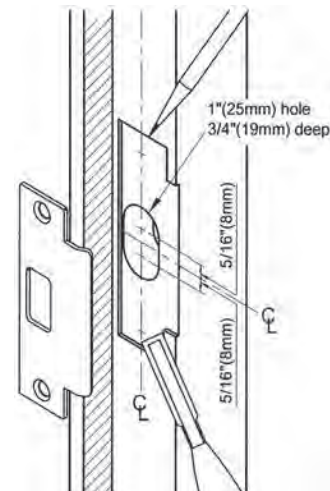



## Step #3 Prepare Lock for Installation

### A. Unpack the Lock

The lock is packed in such a way to represent how it will install on the door.

Before installation:

1. Disassemble the inside escutcheon.
  - 1) Remove the inside lever and spacer bushing with the lever removal tool provided.
  - 2) Separate the mounting plate assembly from the inside escutcheon.
2. Remove the battery cover
  - 1) Unscrew the battery cover screw using the #2 phillips screw driver.
  - 2) Take the battery cover off.

The outside assembly stays assembled.

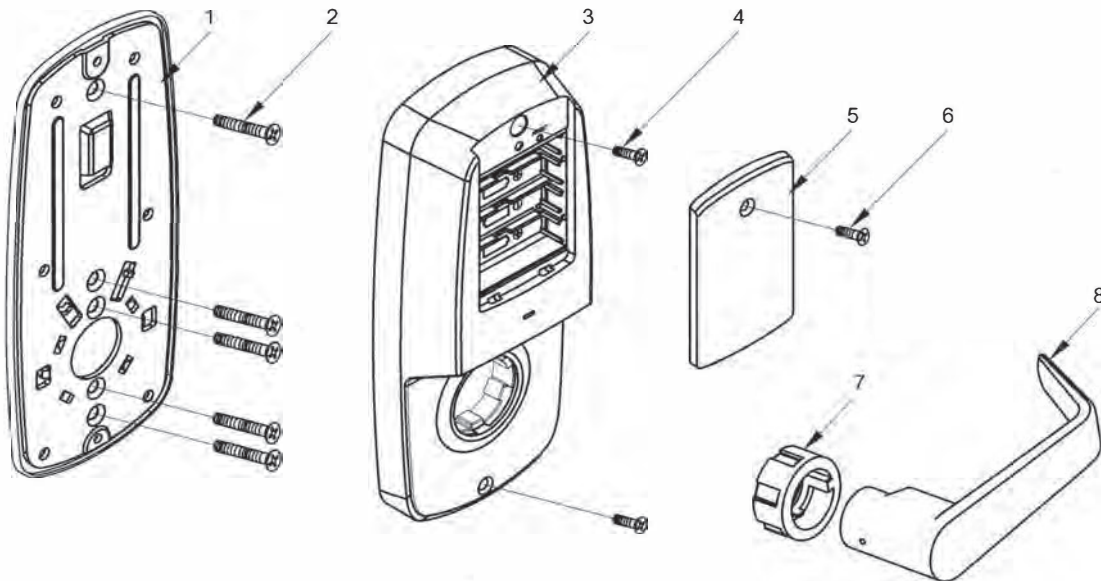

1. Mounting Plate Assembly
2. Mounting Plate Screws

3. Inside Escutcheon
4. Inside Escutcheon Screw

5. Battery Cover
6. Battery Cover Screw
7. Spacer Bushing
8. Inside Lever

### B. Adjust for Door Thickness (If Necessary)

- ☞ Lock is factory-assembled for 1-3/4"(45mm) thick doors.
- ☞ It can be adjusted for door thickness range from 1-3/8"(35mm) to 1-3/4"(45mm) doors.



### Adjustment for different door thickness:

1. Remove outside lever spacer bushing and outside assembly (See C below).
2. Rotate outside mounting rose plate for proper door thickness as shown below.
3. Position of bent taps as shown below must match (ensure the bent taps are horizontally crossed).
4. Reassemble outside assembly spacer bushing and outside lever by reversing procedures.

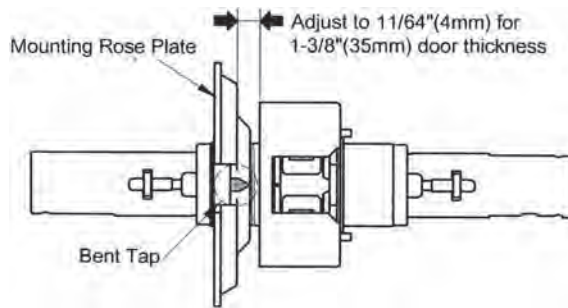

In case of 1-3/8"(35mm) thick door

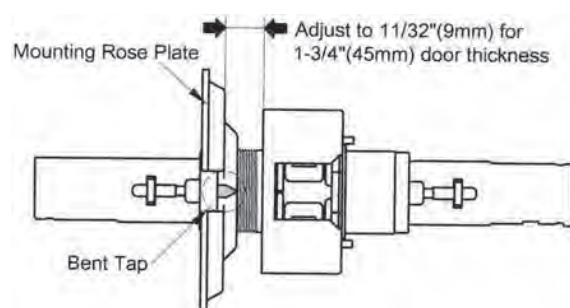

In case of 1-3/4"(45mm) thick door

### C. How to Replace, Re-Key or Install Cylinder (If Required)

1. Remove outside lever
  - 1) Insert key rotate 45° clockwise and hold.
  - 2) Depress lever retainer with lever removal tool (provided).
  - 3) Slide lever off lock.
2. With outside lever in hand use standard pliers to pull out cylinder retainer.
3. Remove key and cylinder from outside lever.
4. Insert new cylinder.
5. Secure by pressing cylinder retainer flush with the lever.
6. Insert key into cylinder.

**Important:** Make sure the key-cut side of key lines up facing towards the end of the lever. If the key is inserted incorrectly the lock will reassemble and might appear to properly work however when the key is removed the latchbolt will remain retracted.

7. Rotate key 45° counterclockwise.  
Push the lever onto the spindle until fully seated.  
Pull on lever to insure properly seated.

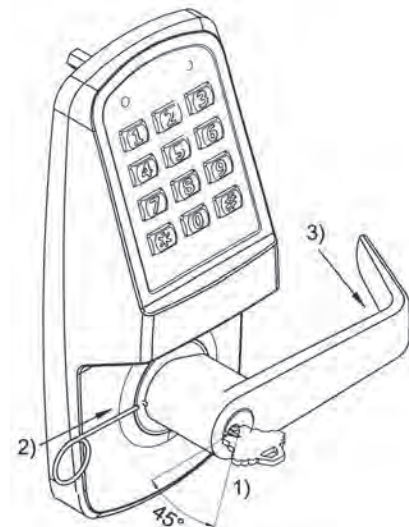

# Step #4 Lock Installation

## Outside Assembly

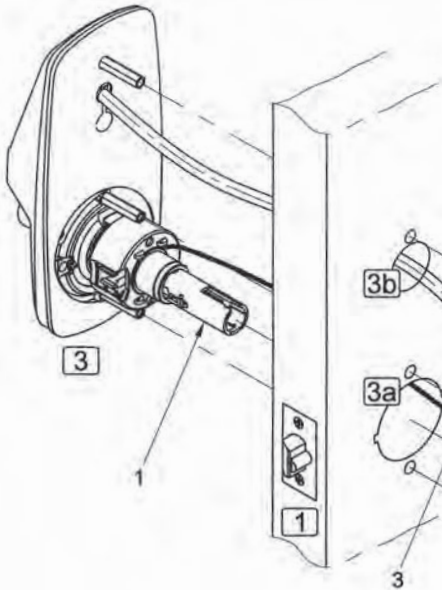

No	Designation
1	Spindle
2	Keypad Cable
3	Motor Cable

## Inside Assembly

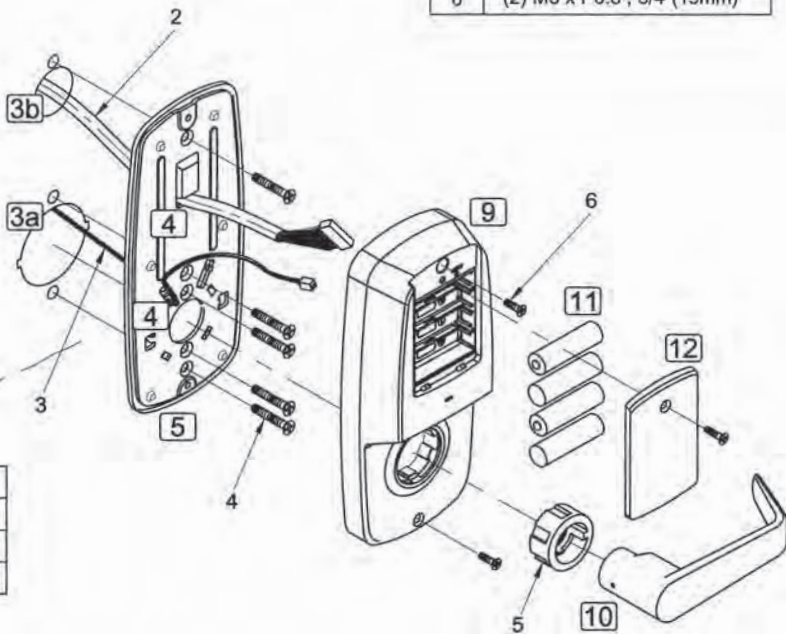

No	Designation
4	(5) 10-32 x 1-1/5"(30.5mm)
5	Spacer Bushing
6	(2) M5 x P0.8 , 3/4"(19mm)

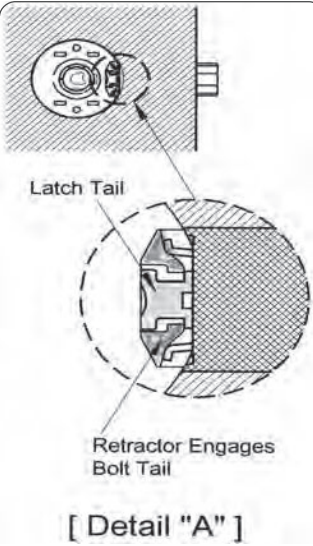
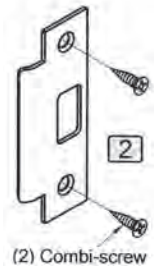
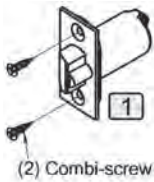

7 Keypad Cable Connector

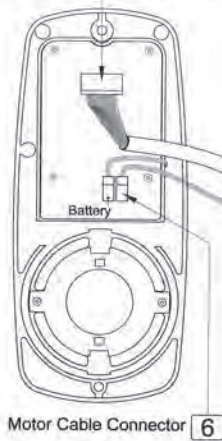

8b Keypad Cable Arrangement

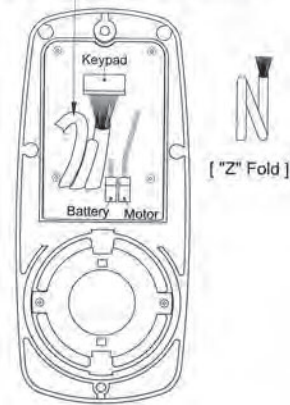

## PROCED RES

1. Install latch in door. Be sure that bevel edge of bolt faces strike. Attach with two screws supplied.
2. Install strike on the door frame.
3. Insert outside assembly through door making sure that the lock body frame hooks latch case and retractor engages bolt tail(s). DO NOT FORCE (See Detail A above). If lock body does not engage latch easily check door preparation for errors.
  - 3a. Guide motor cable (red and black wires) through 2-1/8"(54mm) diameter hole.
  - 3b. Guide pushbutton cable through 1"(25mm) diameter upper hole.
4. Guide motor cable and touchpad cable through rectangular holes on mounting plate assembly (motor cable - below rectangular hole / pushbutton cable - above rectangular hole).
5. Slide mounting plate assembly over outside assembly lining up top and bottom screw guides with holes in door. Secure both assemblies with (5) 10-32x2-9/16" (35mm) mounting plate assembly screws. Do not over-tighten.
6. Attach motor cable connector to the inside escutcheon PC board lower header.
7. Attach the pushbutton cable connector to the inside escutcheon PC board header as illustrated.
8. Slide inside escutcheon over mounting plate assembly.

**CAUTION :**

  - 8a. Position motor cable against mounting plate assembly. Avoid pinching wires against spindle and any sharp metal part of the assembly.
  - 8b. Fold touchpad wire cable and lay against the back recessed area of the inside escutcheon. Position and bend wires to prevent binding when installing the inside escutcheon over the mounting plate assembly.
9. Install and secure inside escutcheon with the (2) M5xP0.8-3/4"(19mm) screws through inside escutcheon and into the mounting plate assembly.
10. Slide inside lever onto spindle and push in to attach.
11. Install (4) AA alkaline batteries into controller compartment being careful to align +/- polarity properly.
12. Install battery cover and tighten screw.

## Step #5 Test Lock Operation

If you encounter problems while performing any of the following tests review the installation instructions and this guide and correct any problems.

**CAUTION** : DOOR MUST REMAIN OPEN DURING INSTALLATION. SET DOOR STOP.

### Mechanical Test

- A. Rotate the inside lever. Operation should be smooth and the latch should retract.
- B. Insert the key into keyway and rotate the key to open the door. Operation should be smooth and the latch should retract.

### Electronic Test

- A. To unlock outside lever.
  - 1. Enter factory defaults Master Code **123456** and press the \* button.
  - 2. Outside lever will retract the latch

## HARDWARE TROUBLESHOOTING

### Test the Operation of the Mechanical Lockset

Cycle the lock in both the locked and the unlocked positions. If problems are found

Symptom	Suggested Action
Door is binding	<ul style="list-style-type: none"> <li>• Check that door and frame are properly aligned and door is free swinging.</li> <li>• Check hinges. They should not be loose or have excessive wear on knuckles.</li> </ul>
Latchbolt will not deadlock	<ul style="list-style-type: none"> <li>• Either strike is out of alignment or the gap between the door and frame is too great.</li> <li>• Realign strike or shim strike out towards flat area of latchbolt.</li> </ul>
Latchbolt does not retract or extend properly	<ul style="list-style-type: none"> <li>• Latchbolt tail and retractor are not properly positioned                             <ul style="list-style-type: none"> <li>☞ Remove lockset. Look through 2-1/8" hole and verify latchbolt tail is centered between top and bottom of hole.</li> <li>☞ Remove latchbolt and insert lockset. Look through latchbolt hole and verify retractor mouth centered in hole. If not adjust outside mounting rose plate.</li> <li>☞ If necessary rebore holes to line up retractor and tail.</li> </ul> </li> </ul>

## PRO RAMMIN IDE

Take the time to read through this guide to familiarize yourself with the features and operation of the lock and its quick and easy programming procedures.

### TABLE OF CONTENTS

Overview	13
Operation of Lock	14 15
Programming Features	16 18
Programming	19 22
Miscellaneous Information	23
Glossary	24
Troubleshooting	25
User PIN Code Record Sheet	26

### OVERVIEW

Stand-Alone Access Control System is a series of State-of-the-Art Microprocessor-Based programmable Keypad Access Lock.

- User Access Methods
  - ☞ Keypad Entered User PIN Codes.
  - ☞ Metal Key cylinder.
- User Features
  - ☞ 100 users.
  - ☞ User code length from 4-6 digits.
- Preparing to Program your Lock
  - ☞ At first glance your new lock may look complicated but it is in fact designed in a very straightforward way. The keypad contains 12 buttons numbers 1 through 9 plus zero a star button \* and a pound button #.
  - ☞ These 12 buttons are all you need to program your lock.
  - ☞ All features can be programmed manually through the Keypad.
  - ☞ This guide will show you how to program your lock manually.
- The lock can be programmed for Passage mode Lockout mode settings. Auto re-lock time and Beep volume are adjustable and can be changed from factory default.

## OPERATION OF LOCK

### Opening the door with a PIN Code

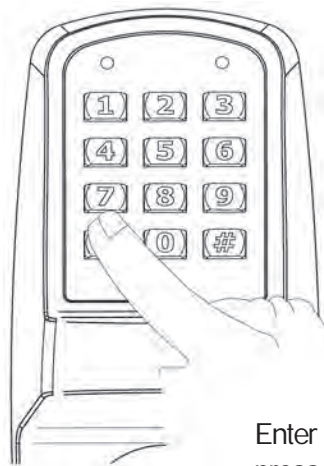
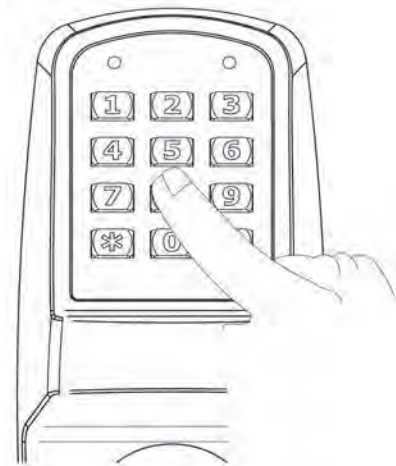

Enter a registered PIN Code and press \* button.

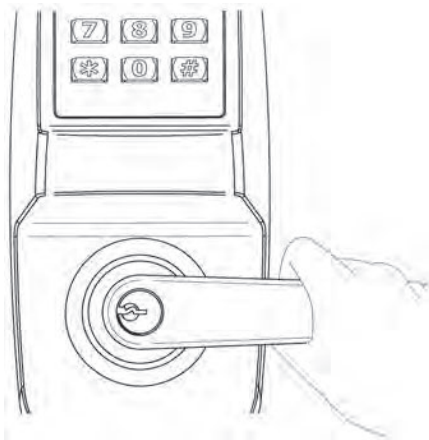

Turn lever to open door.

### Opening the door with a Metal Key

- A. Insert the key into keyway.
- B. Rotate the key to open the door.



## Factory Defaults

Settings	Factory Defaults
Master PIN Code	123456
Lockout Mode	nprogrammed
Passage Mode	nprogrammed
Re-lock Time	5 seconds
Wrong Code Entry Limit	5 times
Shut Down Time	60 seconds
Beep olume	2 levels

## Scope of Master Manager ser Settings

Settings	Master	Manager	ser
Entrance Authori ation	√	√	√
Register/Change Master PIN Code	√		
Register/Delete Manager PIN Code	√		
Register/Delete ser PIN Code	√		
Registering One-time ser PIN Code	√		
Setting p/Releasing ser Lockout Mode	√	√	
Entrance Authori ation at Lockout Mode	√	√	
Setting p/Releasing Passage Mode	√	√	
Setting p the Sound olume	√	√	
Setting p the Re-lock Time	√	√	



## PRO RAMMIN FEAT RES

Outside

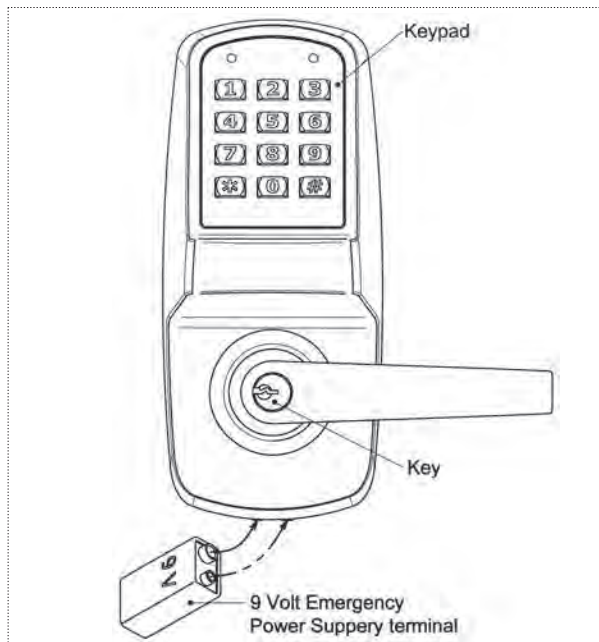

Inside

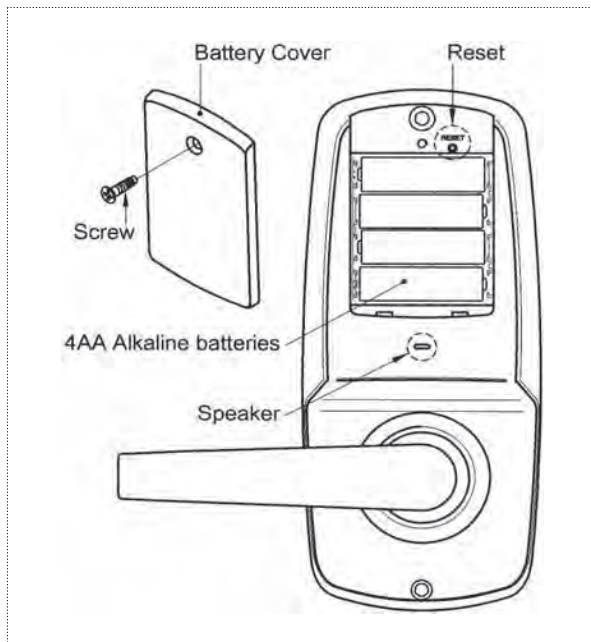

## Menu and Icons

Symbols	Description
0 ~ 9	Press the indicated number buttons.
*	Press the * button. It is used to complete an input process.
#	Press the the # button. It is used to enter Programming mode.
Mstr PIN	Enter the Master PIN Code (Only 6 digits in length) Factory Default 123456
Mgr PIN	Enter the Manager PIN Code (4 6 digits in length).
PIN	Enter the ser PIN Code (4 6 digits in length).

## To Begin Programming

The Lock is preset at the factory with Master PIN Code 123456 . (Only 6 digits in length)

- A. Entering **1 2 3 4 5 6 \*** will unlock the lock allowing the outside lever to retract the latchbolt.
- B. Entering **1 2 3 4 5 6 #** will put the lock in the programming mode.

**Note :** Factory recommend to change the default master code before adding users.

## Feature Programming Through Master Code

### Programming Overview

- Step 1 Put the lock in the programming mode. - Enter Master PIN Code then press **#** .
- Step 2 Enter the digit (0 - 7) corresponding to the task then press **#** .
- Step 3 Enter the code you want to add delete or change then press **#** .
- Step 4 Press **#** again to confirm the programming.
- Step 5 Finish programming by pressing **\*** .

### Change Default Master Code Before Programming

Step 1	Step 2	Step 3	Step 4	Step 5
Default <b>Mstr</b> PIN	<b>#</b> → <b>1</b> <b>#</b> →	Enter New <b>Mstr</b> PIN	<b>#</b> → Enter New <b>Mstr</b> PIN	<b>#</b> → <b>*</b>

### Register User PIN Code

**Mstr** PIN **#** → **2** **#** → Enter  PIN **#** → **#** → **\***

### Delete registered PIN Code except Master PIN Code

**Mstr** PIN **#** → **3** **#** → Registered  PIN **#** → **#** → **\***  
 Registered **Mgr** PIN **#** → **#** → **\***

### Register One-Time User PIN Code

Mstr PIN # → 4 # → One-Time PIN # → # → \*

### Register Manager PIN Code

Mstr PIN # → 6 # → Enter Mgr PIN # → # → \*

☞ The following steps can be done by Manager PIN or Master PIN.

### Setting Up/Releasing Passage Mode

Mstr PIN or Mgr PIN # → 5 # → 1 Enable \*

→ 3 Disable \*

☞ **Another method to disable Passage Mode** Press the \* button for 5 seconds will disable Passage Mode.

☞ **NOTE** When the lock is in Passage Mode pressing any key will cause a double-beep and the green LED will blink. Green and Red LED will turn on then enter Master or Manager PIN.

### Setting Up/Releasing Lockout Mode

Mstr PIN or Mgr PIN # → 7 # → 1 Enable \*

→ 3 Disable \*

☞ **NOTE** When the lock is in Lockout Mode pressing any key will cause a double-beep and the Red LED will blink. Green and Red LED will turn on then enter Master or Manager PIN.

### Setting Up the Sound Volume or Re-lock Time

Mstr PIN or Mgr PIN # → 0 # → 1 olume # → 1 4 \*

→ 2 Re lock Time # → 1 9 \*

☞ **Sound Volume** 1 minimum volume 3 maximum volume 4 mute.

☞ **Re-lock Time** 1 to 9 seconds through feature settings. (factory default 5 five seconds)

## PRO RAMMIN

### Change Default Master Code Before Programming

**Note** : Factory recommend to change the default master code before adding users.

Default MstrPIN # → 1 # → Enter New MstrPIN # → Enter New MstrPIN # → \*

1. Enter the default Master PIN Code 1 2 3 4 5 6 and press the # button  
green and Red LED blink green and Red LED will turn on.
2. Enter the digit 1 and press the # button.  
green and Red LED blink green and Red LED will turn on.
3. Enter the new Master PIN Code and press the # button.  
Beep melody with green LED blink green and Red LED will turn on.
4. Enter the new Master PIN Code again and press the # button.  
Beep melody and green and Red LED will turn on.
5. Press the \* button.  
Completes with beep sound.

**For example** if you want to change new Master PIN Code to "258013". (Only 6 digits in length)

1 2 3 4 5 6 # → 1 # → 2 5 8 0 1 3 # → 2 5 8 0 1 3 # → \*

### Register User PIN Code

MstrPIN # → 2 # → Enter PIN # → # → \*

1. Enter the Master PIN Code and press the # button.  
green and Red LED blink green and Red LED will turn on.
2. Enter the digit 2 and press the # button.  
green and Red LED blink green and Red LED will turn on.
3. Enter the new User PIN Code and press the # button.  
Beep melody with green LED blink green and Red LED will turn on.

4. Press the **#** button.  
Beep melody and Green and Red LED will turn on.  
☞ Repeat steps 3 and 4 for each new user (if necessary).
5. Press the **\*** button.  
Completes with beep sound.

Program the lock by pressing **Mstr**PIN **#**→**2** **#**→**111222** **#**→**\***

### Delete registered PIN Code except Master PIN Code

**Mstr**PIN **#**→**3** **#**→ Registered  PIN **#**→ **#** → **\***

1. Enter the Master PIN Code and press the **#** button.  
Green and Red LED blink Green and Red LED will turn on.
2. Enter the digit **3** and press the **#** button.  
Green and Red LED blink Green and Red LED will turn on.
3. Enter the registered PIN Code and press the **#** button.  
Beep melody with Green LED blink Green and Red LED will turn on.
4. Press the **#** button.  
Beep melody and Green and Red LED will turn on.  
☞ Repeat step 3 and 4 for delete of another registered PIN Code (if necessary).
5. Press the **\*** button again.  
Completes with beep sound.

Program the lock by pressing **Mstr**PIN **#**→**3** **#**→**111222** **#**→**\***

### Register One-Time User PIN Code

**Mstr**PIN **#**→**4** **#**→ One-Time  PIN **#**→ **#** → **\***

Mstr<sup>PIN</sup> or Mgr<sup>PIN</sup> #→5 #→1 Enable \*

→3 Disable \*

1. Enter the Master PIN Code or Manager PIN Code and press the **#** button.  
Green and Red LED blink Green and Red LED will be turned on.
2. Enter the digit **5** and press the **#** button.  
Green and Red LED blink Green and Red LED will be turned on.
3. Enter the Enable Code **1** or Disable Code **3** and press the **\*** button.  
Completes with beep sound.

DWG # ELG8039-06/25-21 of 27

## Setting p/Releasing Lockout Mode

MstrPIN or MgrPIN # → 7 # → 1 Enable \*

→ 3 Disable \*

1. Enter the Master PIN Code or Manager PIN Code and press the # button.  
Green and Red LED blink Green and Red LED will turn on.
2. Enter the digit 7 and press the # button.  
Green and Red LED blink Green and Red LED will turn on.
3. Enter the Enable Code 1 or Disable Code 3 and press the \* button.  
Completes with beep sound.

## Register Manager PIN Code

MstrPIN # → 6 # → Enter MgrPIN # → # → \*

1. Enter the Master PIN Code and press the # button.  
Green and Red LED blink Green and Red LED will turn on.
2. Enter the digit 6 and press the # button.  
Green and Red LED blink Green and Red LED will turn on.
3. Enter the Manager PIN Code and press the # button.  
Beep melody with Green LED blink Green and Red LED will turn on.
4. Press the # button.  
Beep melody and Green and Red LED will turn on.  
☞ Repeat steps 3 and 4 for another manager PIN Code (if necessary).  
☞ You may register up to 3 Manager PIN Codes.
5. Press the \* button again.  
Completes with beep sound.



## MISCELLANEOUS INFORMATION

### Returning the Lock to Factory Defaults

1. Remove battery cover using #2 phillips screw driver.
2. Push and hold the Reset Button with the lever removal tool provided for 10 seconds.
3. After beep all numbers of keypad will blink for about 20 seconds. Please wait until it stops blinking.

**Note:**

All registered Master Manager and User PIN Code data etc. will be deleted and the lock will reset to the factory default.

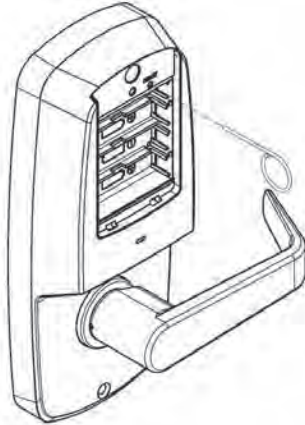

### 9 Battery Emergency Power

9 battery connections are located under the front of the outside assembly.

In the case that the 4 AA alkaline batteries are completely discharged a 9 battery can be used to supply power to the lock.

While connecting the 9 battery the lock can be operated as normal thus granting access so the 4 AA alkaline batteries can be replaced.

Discharged batteries should be replaced right away.



### Battery Replacement

When battery power is low Green and Red LED will blink with beep sound.

Replace low batteries as soon as possible. The locks use four (4) AA-size 1.5 volt alkaline batteries.

## LOSSARY

**Master PIN Code:** The Master PIN Code is used for programming user codes and feature settings. The Master PIN Code will operate the lock. The Master PIN Code is a factory default setting.

**Manager PIN Code:** The Manager PIN Code is used for programming Passage Mode Lockout Mode and Sound volume and Auto re-lock time settings. The Manager PIN Code will operate the lock. User can program in up to 3 different Manager PIN Codes.

**User PIN Code:** The User PIN code is used for operating the lock.

**One-Time User PIN Code:** This PIN Code can only be used once and the PIN information is deleted automatically after use. User can program in up to 3 different One-Time User PIN Codes.

**Passage Mode:** Enabling Passage Mode allows continuous entry for non-restricted traffic. Passage Mode is enabled or disabled through feature programming by either the Master or Manager PIN Code. When the lock is in Passage Mode the green light will blink 5 times.

**Lockout Mode:** This feature is enabled by either the Master or Manager PIN Codes. When enabled it restricts all User PIN Code access except Master and Manager PIN Codes. When the lock is in Lockout mode the red light will blink 5 times.

**Low Battery:** When battery power is low Green and Red LED will blink with beep sound. If battery power is completely out you can access to the lock with a key.

**Re-lock Time:** After successful code entry and the unit unlocks it will automatically re-lock after a default of five (5) seconds. Re-lock time is adjustable from one (1) to ten (10) seconds through feature settings.

**Beep Volume:** It sets the volume of sound emitted during the inputting of numbers and opening or locking the door. (Level 1 Level 4) The sound is muted at Level 4 and is at the maximum volume at Level 3. The factory default is Level 2.

**Shut Down Time:** The unit will shut down for a default of sixty (60) seconds and not allow operation after the wrong code entry limit has been met. Shut down time is factory default settings. When the lock is in Shut Down mode Red LED will blink with beep sound.

**Wrong Code Entry Limit:** After five (5) unsuccessful attempts entering a valid PIN Code the unit will shut down and not allow operation for sixty (60) seconds. Wrong code entry limit is a factory default setting.

## TROUBLESHOOTING

Symptom	Suggested Action
There is no power.	<ul style="list-style-type: none"> <li>• Check if the batteries are faulty or in the correct polarity.</li> <li>• Check if the batteries are inserted properly or completely discharged.</li> <li>• Check wires if properly connected and no damage.</li> </ul>
I can't change the Master PIN Code.	<ul style="list-style-type: none"> <li>• There was a delay while entering the new Master PIN Code. Also after entering the first digit the next digit must be entered within 10 seconds.</li> <li>• If batteries are discharged try again after replacing the batteries.</li> <li>• Refer to the changing the Master PIN Code section in the programming instructions and try changing again.</li> </ul>
I can't change the user PIN Code.	<ul style="list-style-type: none"> <li>• The desired user PIN is already in use.</li> <li>• If the PIN Code is less than 4 digits or over 6 digits in length change it to be within 4-6 digits and register again.</li> </ul>
I entered registered PIN Code and pressed the * button but the door won't open.	<ul style="list-style-type: none"> <li>• Check that the registered PIN Code was entered correctly.</li> </ul>
The door won't lock automatically when I close it.	<ul style="list-style-type: none"> <li>• Check if Passage mode is set. If the door opens up by turning the handle on the outside assembly down without any input on the lock it means the Passage mode is enabled.</li> <li>• If the door doesn't lock automatically when Passage mode is disabled then the lock has been installed incorrectly. Have a locksmith check the lock or call Tech Support.</li> </ul>
The lock issues the low voltage warning sound when I activate the lock.	<ul style="list-style-type: none"> <li>• The sound indicates that it is time to replace the batteries. Replace with new batteries as soon as possible.</li> </ul>
Lock does not respond door is locked and inaccessible.	<ul style="list-style-type: none"> <li>• Batteries may be completely discharged.</li> <li>• Use mechanical key to gain entry and replace batteries.</li> <li>• Connect a 9-volt battery to the emergency power supply terminal which is located on the outside escutcheon under the lever. With the 9-volt battery connected press the wake up button and enter PIN code. Replace batteries.</li> </ul>
The unit is on for a while and then shows no reaction. Lights dim.	<ul style="list-style-type: none"> <li>• The batteries do not have enough power. Replace the batteries.</li> </ul>

## SER PIN CODE RECORD SHEET

[illegible]

※ We recommend placing this record sheet in a safe and secure place.



