

## LSD STANDARD DUTY DEADBOLTS

### FOR LIGHT COMMERCIAL AND RESIDENTIAL APPLICATIONS

Conforms with ANSI A156.2  
Series 4000, Grade 3

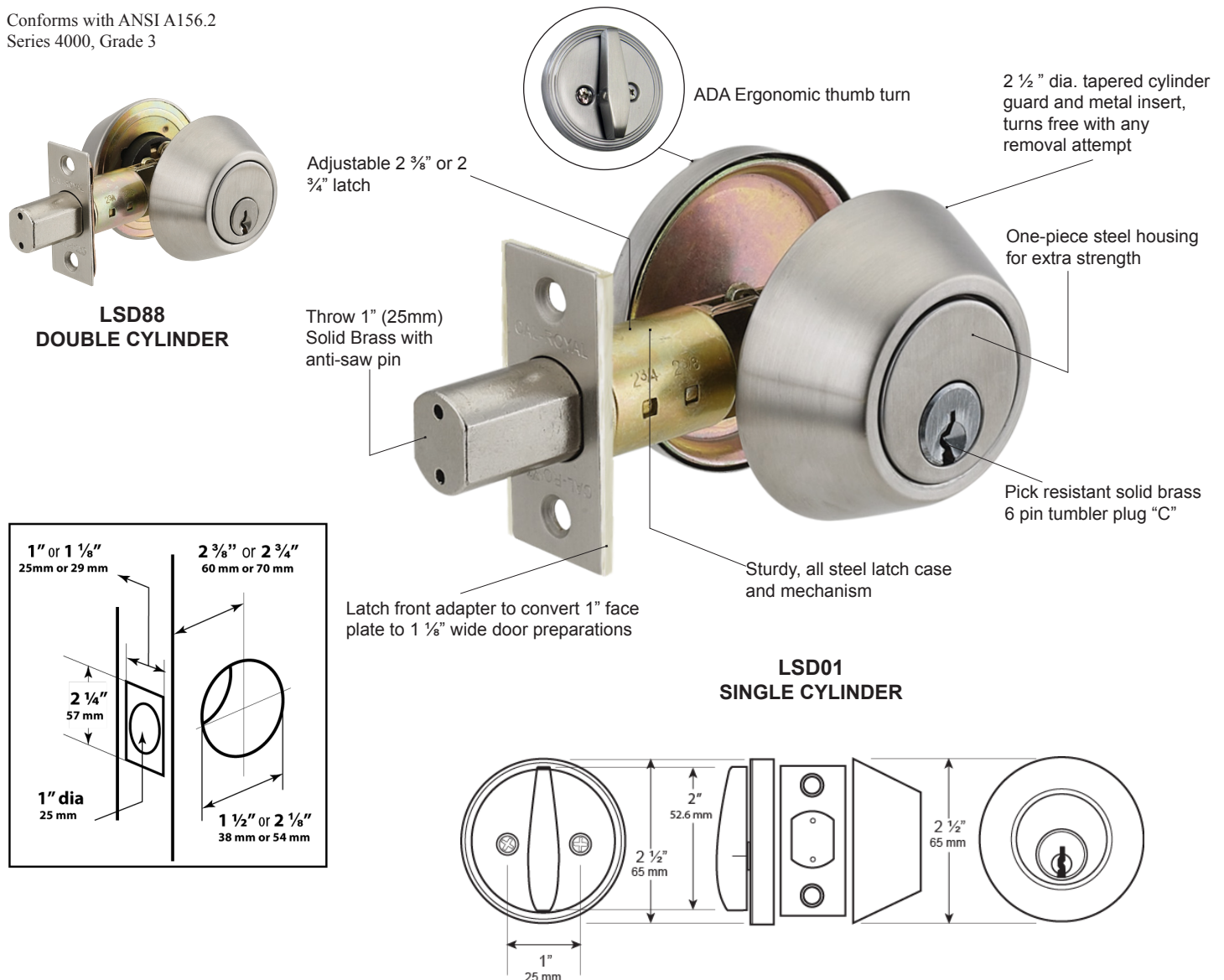

### SPECIFICATIONS

#### TRIM

Wrought Brass or Stainless Steel.

#### BACKSET

Adjustable 2 3/8" or 2 3/4".

#### DEADBOLT FACEPLATE

Standard 2 1/4" x 1". Packed with 1/8" plastic filler to convert 1" face plate to 1 1/8" wide door preparations.

#### DOOR RANGES

Adjustable 1 3/8" (35mm) to 1 3/4" (45mm) door thickness.

#### BORE DIAMETER

1" for latch, 1 1/2" or 2 1/8" for lock housing.

#### KEYWAYS

6 pin solid brass "C" keyway standard. Optional Schlage E, Schlage C-K, Russwin D1-2-3-4, Corbin 59 / 60, Corbin-Russwin L4, Sargent LA-LB-LC, Falcon / Weiser E, Arrow A, Yale 8, Yale GA and Kwikset. Can also accept Medeco, Assa, Kaba and Cal-Royal (HSK) High Security Cylinders.

#### STRIKE

1 1/8" x 2 3/4" square corner.

#### FINISHES

LSD SERIES is available in stock in US32D, 26, 26D, 10B, US3 and US15 finishes. Refer to price list for other stock finishes and functions.