

Features

- Secure, economical and durable solution for gates
- Water drainage function for gates or semi-outdoor applications
- One piece cast zinc alloy construction
- Use with bored cylindrical locksets

Specifications

- Voltages: 12 / 24 VDC / AC Intermittent Duty; **No Polarity** (Intermittent use: Not to exceed 20 seconds)
- Operating Temperature: -10°~49°C (14°~120°F)
- Humidity: 0~85% non-condensing
- Latch Throw: 9/16" (15mm)
- Cycle Test: 250,000+ cycles
- Fail-secure
- Keeper Width: 1 5/8" (41mm)
- Holding Force: 1,000 lbs (454Kg)
- Finish: Aluminum or US1 (Black)
- Weight: 343g

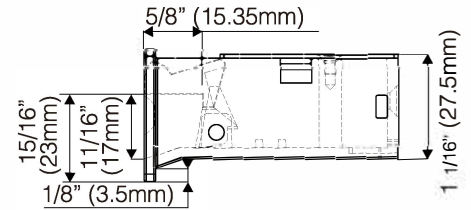
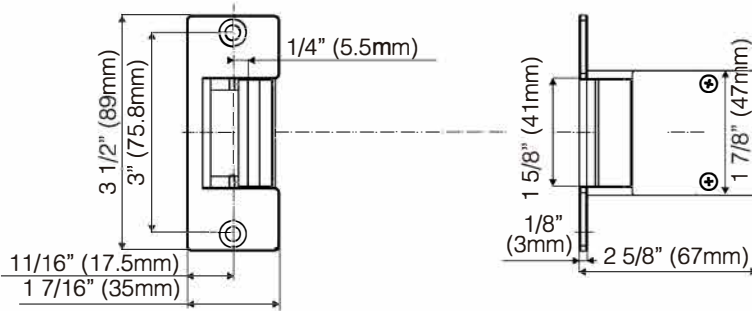

Frame Applications

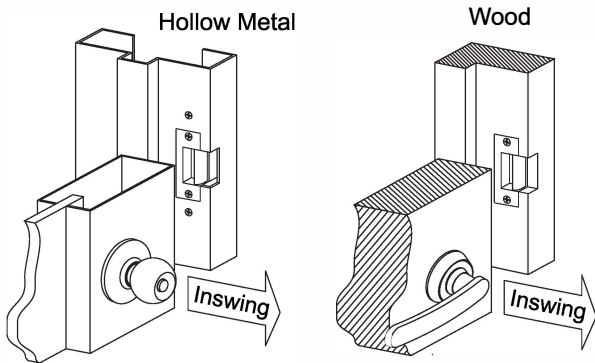

Compatible Locks

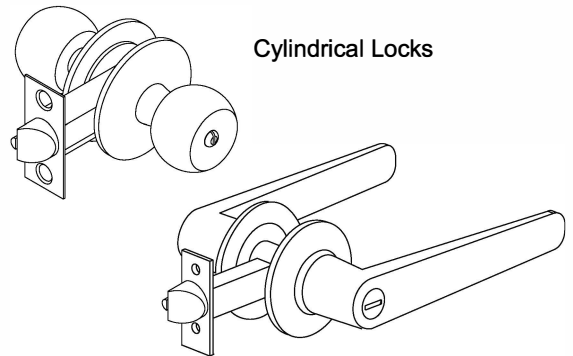

Electric Strike Installation

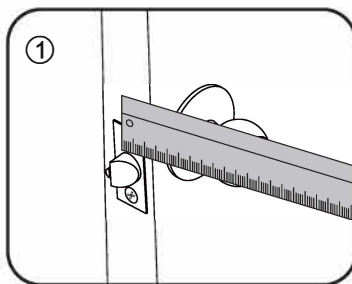

Measure latch position.

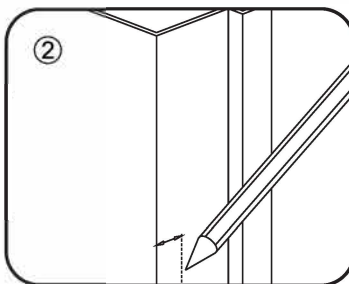

Mark latch position line.

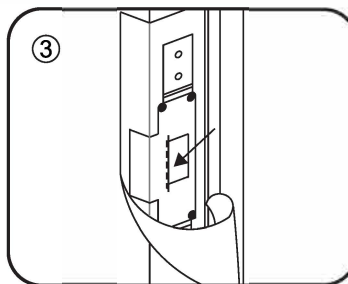

Attach sticker template to the marked center line.

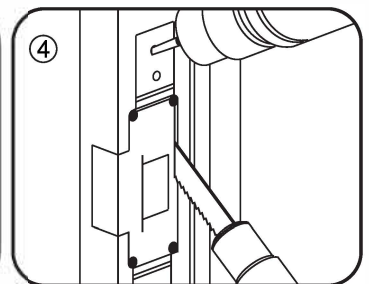

Drill and cut the frame according to the template.

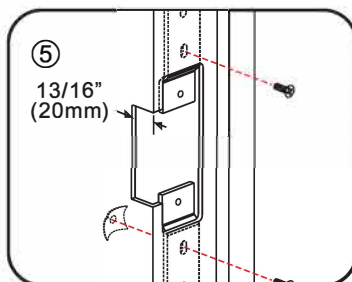

Attach mounting tabs if needed.

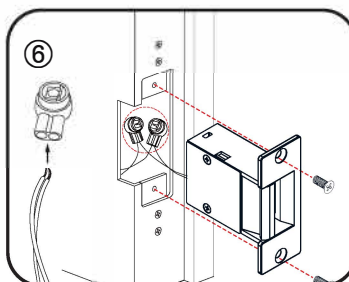

Connect the wires using the crimp connectors, then test the strike, ensure you give it correct voltage.

Installing the Crimp Connectors:

Crimp connectors are provided to make wiring connections easier and more reliable.



To install connectors:

1. Insert the wires into the connector.
2. Use a crimping tool or pliers to evenly press down on the head of the connector.