

FLR7700 KIT INSTALLATION INSTRUCTION

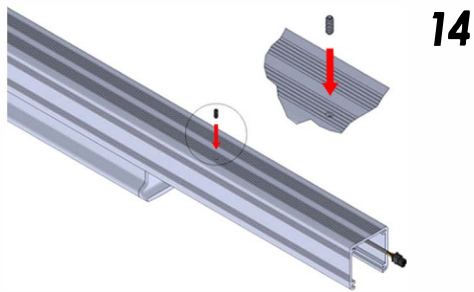

Flip over the Mount Base and push the Kit Assembly to align both kit hole and Mount Base hole, then fasten stop screw.

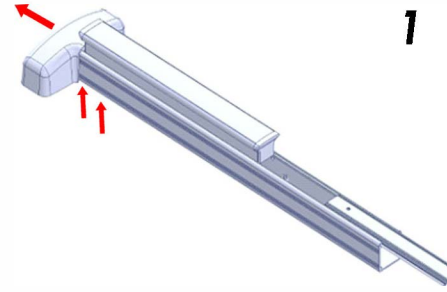

Unfasten fixed screws and remove Device Head.

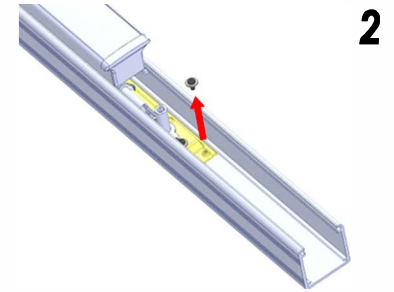

Flip over and remove the sliding shim cover.

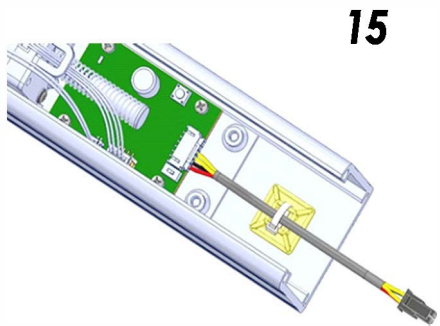

Stick the tie mount and use the cable tie to fix cable in place.

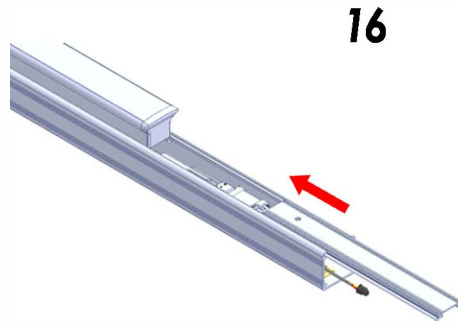

Slide shim cover back into place.

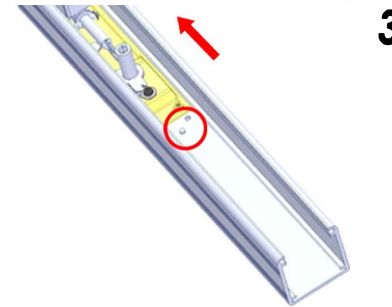

First, push the assembly to the left side and make space to remove the bump. This also ensures you don't damage other parts of the device.

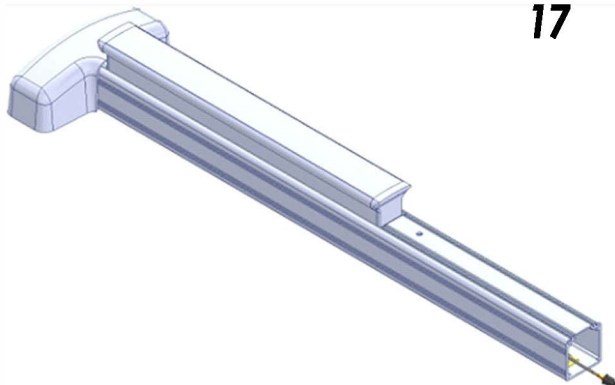

Assembly Completed.

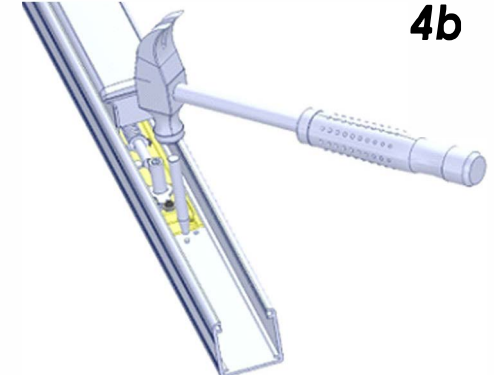
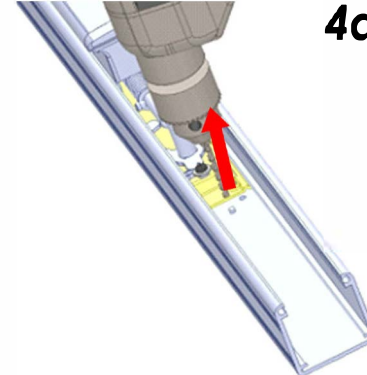

There are two methods to remove the bump. (4a) Electric Drill (4b) Hammer.

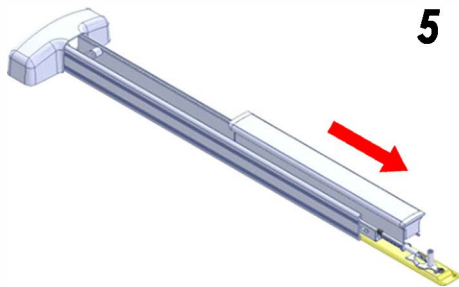

5

By removing the bump, you can now remove the Push Rail Assembly.

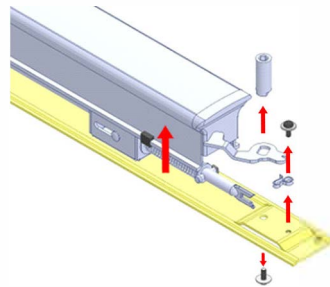

6

You need to remove two (2) screws, then you can remove the normally open mechanism.

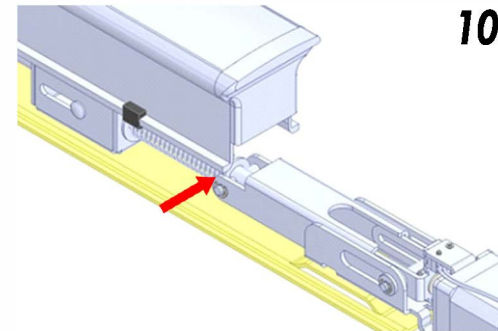

10

ELR Kit Assembly completed.

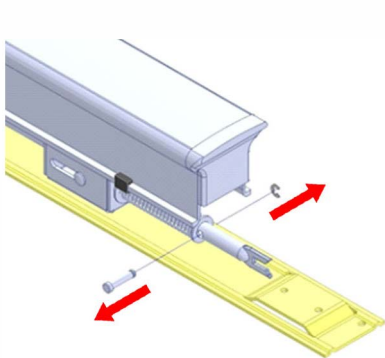

7

Connect the ELR Kit and the Push Rail.

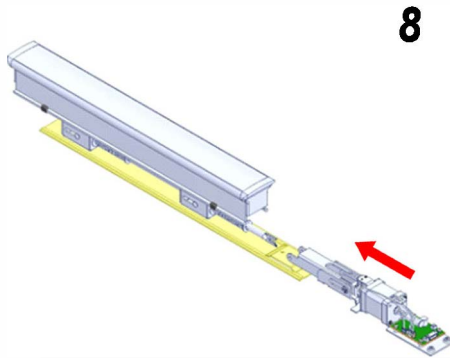

8

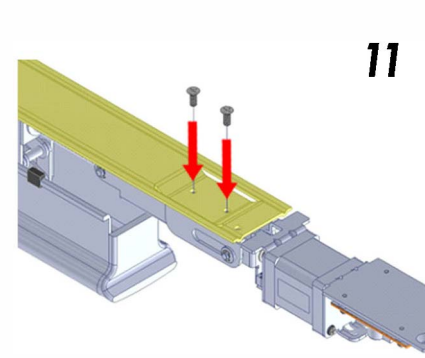

11

Turn over the Assembly Unit and fix by two (2) screws.

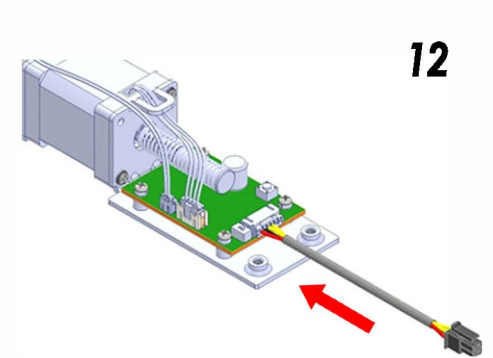

12

Plug in the connector cables.

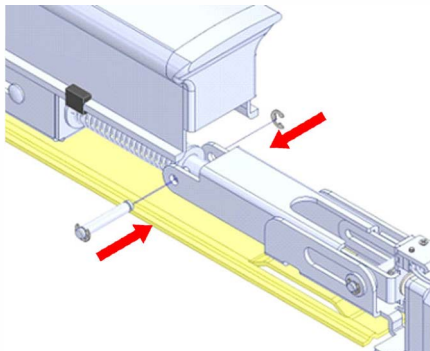

9

Push Roll Pin through Exit Device and Push Rail holes and attach C-clips.

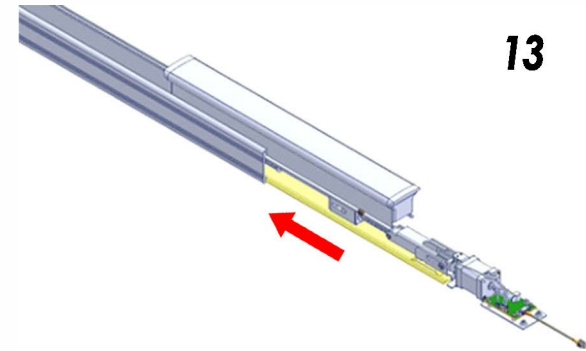

13

Slide the assembly unit back to the Mount Base

