

IND90-G2 Indicator Deadbolts

COMMERCIAL INDICATOR DEADBOLTS,
ANSI A156.36, GRADE 2

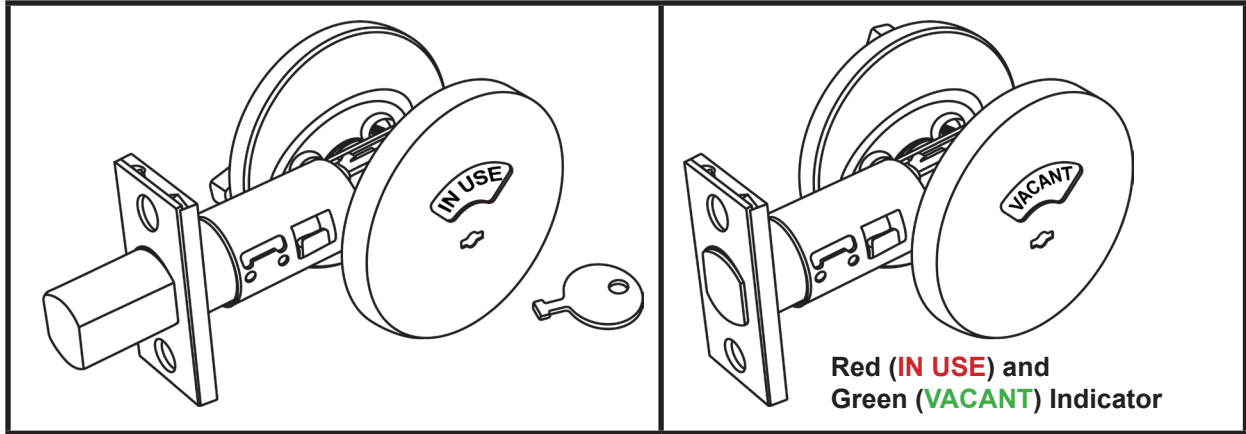

ITEM #	DESCRIPTION	FINISH	PCS / MC
IND90-G2	Indicator Deadbolt	US26D, 26, 10B, 4, 3, 1	20

► **PACKAGING INCLUDES**

- UL Listed Adjustable 2 3/4" and 2 3/8" backset
- 1 1/8" x 2 3/4" Deadbolt Security Strike with 2 pcs. # 10 x 3" wood screws
- 1 1/8" x 2 3/4" square corner strike
- 4 pcs. # 6 x 3/4" combination wood / machine screws
- UL Latch: Backset latch size 1" x 2 1/4" faceplate. Latch front adapter is provided to convert 1" face plate for 1 1/8" wide door preparations.
- Emergency Key included to unlock the deadbolt from the outside.

► **ADDITIONAL PARTS & CHARGES**

ILLUSTRATION	ITEM #	DESCRIPTION	FINISH
	ULJHILADJ	2 3/8" - 2 3/4" UL Listed Adjustable Deadbolt Latch	US3, 26D, 10B
	LFA18	Latch front adapter to convert 1" face plate to 1 1/8" wide door preparations	CLEAR
	T2STRK	Deadbolt Strike 1 1/8" x 2 3/4"	US3, 10B, 26D
	DBFLS	Deadbolt Full Lip Strike, Round Corner	US3, 10B, 26