

Installation Instruction for IND 90

Grade 2 Heavy Duty Deadbolt

2. Drill holes

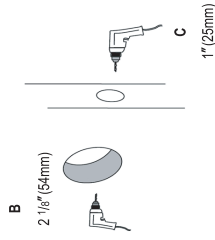

- Determine backset (2 3/4" or 2 1/2") of the lock.
- Drill a 2 1/8" (54mm) hole through both sides of the door as shown.
- Drill a 1" (25mm) hole into front face of the door.
Be certain holes are perpendicular.

3. Install Dead Bolt

Adjustable deadbolt is factory preset 2 3/4" (70mm) backset.

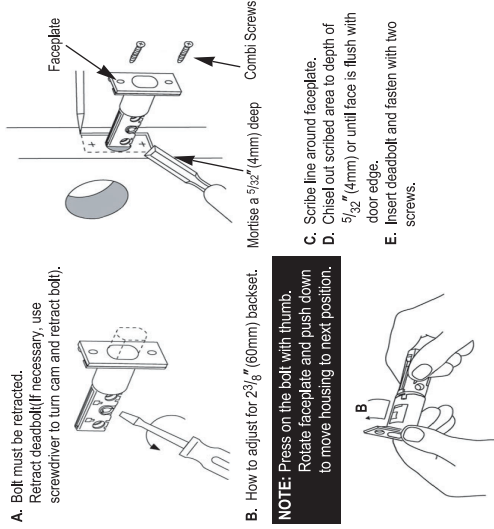

NOTE: Press on the bolt with thumb. Rotate faceplate and push down to move housing to next position.

4. Prepare Door Jamb

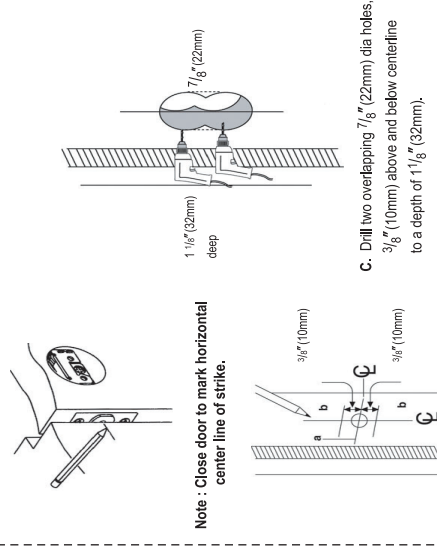

- Locate exact centerline of bolt and mark centerline on jamb.
- Mark drill points 3/8" (10mm) above and below centerline.

5. Install Strike

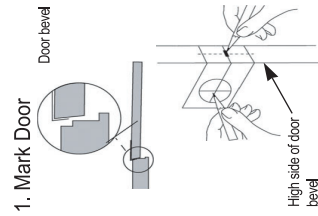

- Place strike box in hole. Place strike over the strike box and use it as pattern for cutout.
- Chisel about 1/8" (3.2mm) deep for flush fit of box and strike.
- Install strike box and strike with combi screws.

5. Install Strike

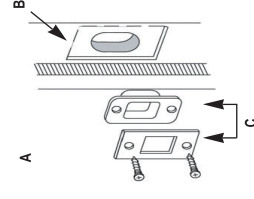

- Place strike box in hole. Place strike over the strike box and use it as pattern for cutout.
- Chisel about 1/8" (3.2mm) deep for flush fit of box and strike.
- Install strike box and strike with combi screws.

6. Single Cylinder Installation Instructions

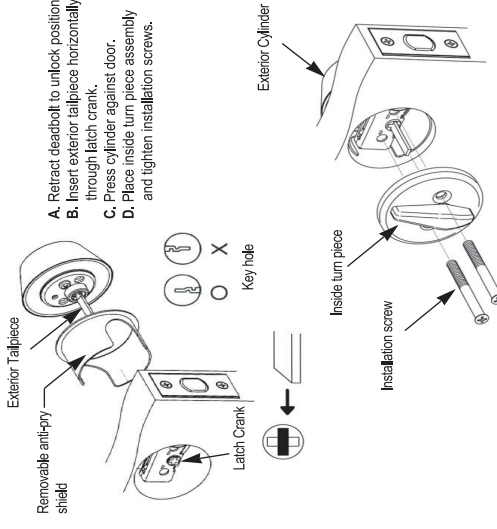

- Retract deadbolt to unlock position.
- Insert exterior tailpiece horizontally through latch crank.
- Press cylinder against door.
- Place inside turn piece assembly and tighten installation screws.

7. Double Cylinder Installation Instructions

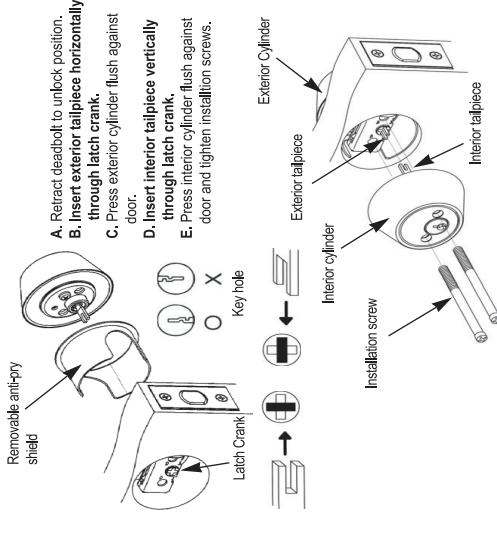

- Retract deadbolt to unlock position.
- Insert exterior tailpiece horizontally through latch crank.
- Press exterior cylinder flush against door.
- Insert interior tailpiece vertically through latch crank.
- Press interior cylinder flush against door and tighten installation screws.

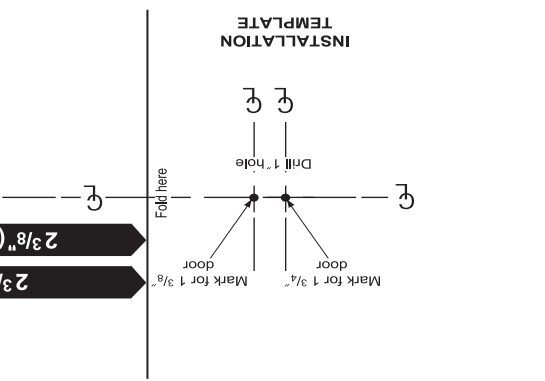
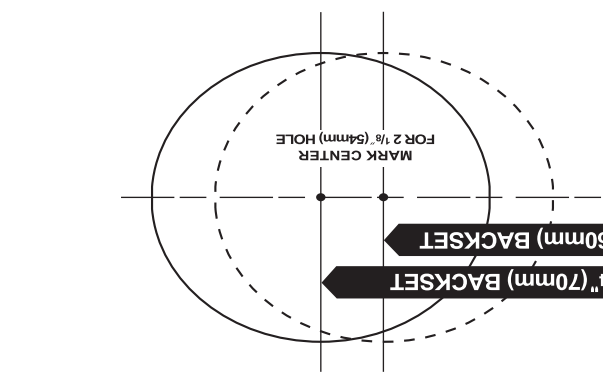

INSTALLATION TEMPLATE

Installation Instruction for IND 90



INSTALL THUMB TURN AND INDICATOR ASSEMBLIES

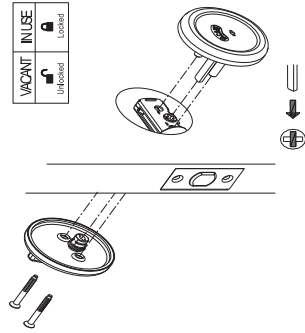

- With the deadbolt latch in the retracted position.
- Rotate the tailpiece of the indicator assembly to the horizontal position (unlocked).
- Insert the tailpiece through the deadbolt latch and hold the indicator assembly flush with the surface of the door.
- Install the thumb turn assembly by rotating the thumb turn in the vertical position and slide the thumb turn assembly over the tailpiece of the indicator assembly.
- Insert mounting screws into the thumb turn assembly, through the deadbolt latch and into the threaded posts on the indicator assembly.
- Tighten screws until the thumb turn and indicator assemblies are tight against the door.

- Check handing of lock installation (RH or LH).
- Insert the cam with Point upward into thumbturn piece.

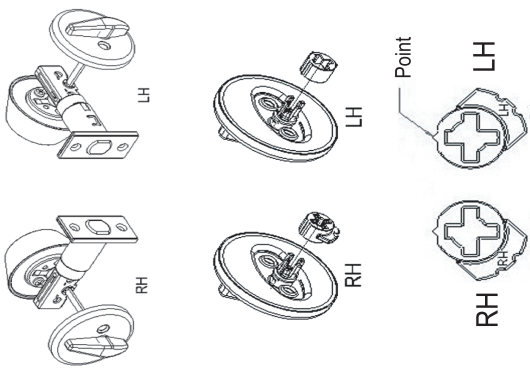

Small Format Interchangeable Core(Optional)

- Align driver as shown below.
- Core Installation : turn control key clockwise, then insert core into deadlock. Turn control key back to vertical position and remove it from the core. Test operation with user key.

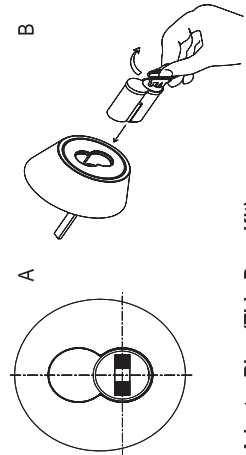

※ Adapter Ring (Thin Door Kit)
To install on 1-3/8" door, use optional adapter ring.

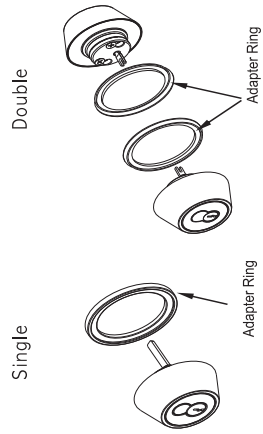

Large Format Interchangeable Core(Optional)

- Align driver as shown below.
- Core Installation : turn control key clockwise, then insert core into deadlock. Turn control key back to vertical position and remove it from the core. Test operation with user key.

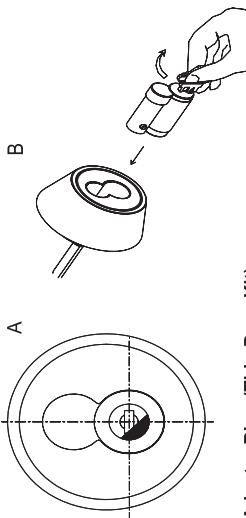

※ Adapter Ring (Thin Door Kit)
To install on 1-3/8" door, use optional adapter ring.

