

INSTALLATION INSTRUCTIONS FOR F7700 SERIES PANIC EXIT DEVICE



BEFORE INSTALLING DEVICE, PLEASE CHECK :

1. IF DOOR FITTED AND HUNG.
2. SIZE OF EXIT DEVICE, FUNCTION AND DESIGN...
 - 2.1. 36" DOORS, CAN BE CUT TO FIT DOORS DOWN TO 30" WIDE.
 - 2.2. 48" DOORS, CAN BE CUT TO FIT DOORS DOWN TO 36" WIDE.
 - 2.3. HAND OF DEVICE AGAINST APPLICATION.

SURFACE OF DOOR FOR EXIT DEVICE APPLIED MUST BE FLUSHED.

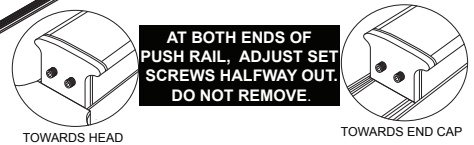
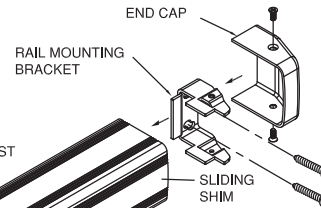

AT BOTH ENDS OF PUSH RAIL, ADJUST SET SCREWS HALFWAY OUT. DO NOT REMOVE.

PANIC BAR SET SCREWS (12-24 X 5/16") MUST BE ACTIVATED AT BOTH ENDS OF PUSH RAIL TO ACHIEVE IMPACT RATING. SET SCREWS TO BE USED IN THE EVENT OF IMMINENT SEVERE WEATHER OF HURRICANE FORCE.

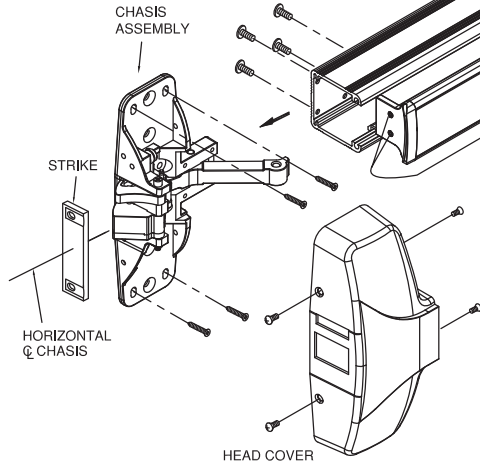

2. APPLY HARDWARE

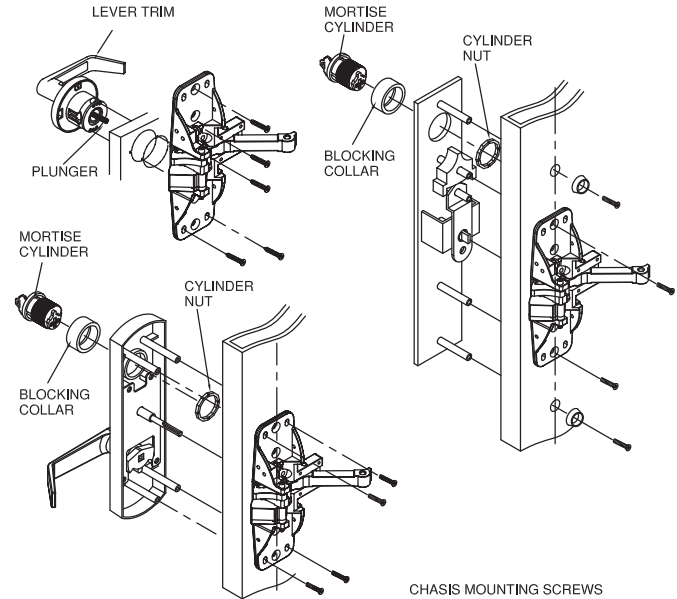

1. PREPARE DOOR

- 1.1 FOR 2 1/8" BORE PREP. POSITION TEMPLATE OVER EXISTING HOLE AND MARK FOR TWO CHASIS MOUNTING SCREW HOLES.

ENSURE VERTICAL \varnothing CHASIS PARALLEL TO DOOR EDGE.

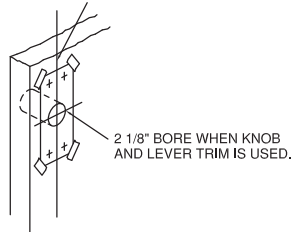

- 1.2 FOR DOOR W/O BORE PREP, MARK VERTICAL \varnothing CHASIS AND HORIZONTAL \varnothing CHASIS USING DIMENSIONS BELOW. MOUNTING SCREW HOLES.

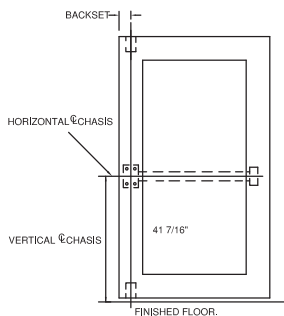

IDENTIFY TYPE OF INSTALLATION TO DETERMINE LOCATION OF VERTICAL \varnothing

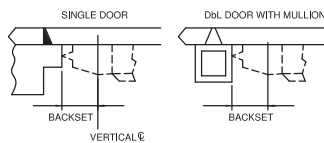

3. APPLY RAIL ASSEMBLY

- 3.1 CHECK THE SIZE OF DEVICE, IF CUTTING TO LENGTH IS REQUIRED.
- 3.2 DETERMINE CUT OFF LENGTH "X" BY SUBTRACTING 1-3/4" FROM "Y". MARK CUT OFF POINT ON MOUNTING RAIL.
- 3.3 DEPRESS ARM INTO RAIL OPENING AND SLIDE RAIL ONTO CHASIS. LEVEL RAIL AND FASTEN CHASIS AND MOUNTING PLATE.

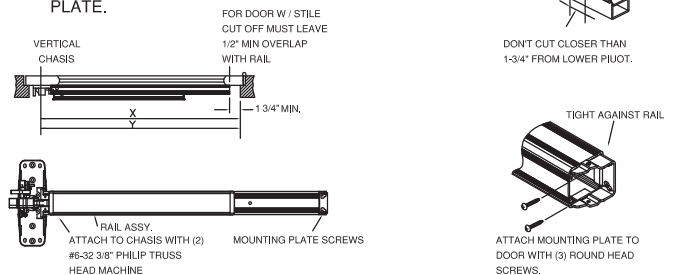

4. APPLY COVER AND STRIKES

