



ULT300LTCH 26D

HOW TO ADJUST ULT300LTCH FROM 2 3/4" TO 2 3/8" OR VICE VERSA.

1. 2 3/4" Backset



2. Throw the bolt using a flathead screwdriver.



3. Turn to the direction as shown.

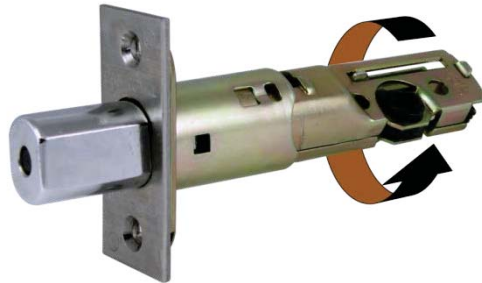

4. Push front and back portion towards each other.

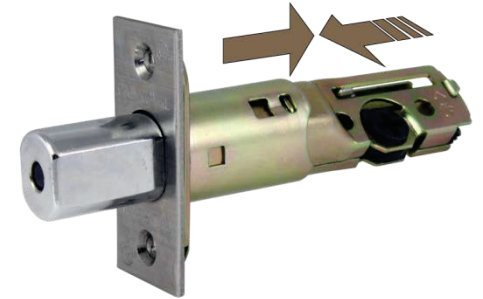

5. Turn to the direction as shown.



6. Retract the bolt. Latch is now 2 3/8" backset.

