

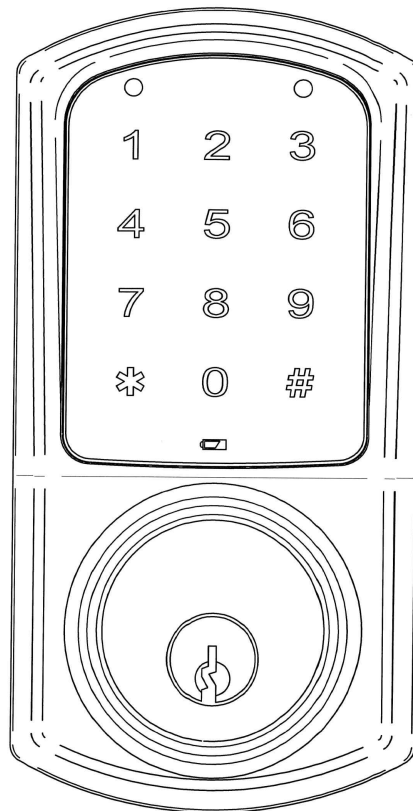

JE-80M

Electronic Stand-Alone Deadbolt

Installation and Programming Instructions



Take the time to read through this guide to familiarize yourself with the features and operation of the lock, and its quick and easy programming procedures.

Please keep this PROGRAMMING INSTRUCTIONS for future reference

■ **Note:** Improper installations may result in damage to the lock and void the factory warranty.

INSTALLATION GUIDE

TABLE OF CONTENTS

Warnings	2
Introduction	2
Specifications	3
Parts Breakdown	3~4
Tools for Installation	4
Door Preparation	5
Prepare Lock for Installation	6~7
Install Lock	8~12

WARNINGS

Warning: *Changes or modifications to this unit not expressly approved by the party responsible for compliance could void the user's authority to operate the equipment.*

- Change your PIN code regularly to ensure the security of your PIN code.
- Keep lock away from wet environments, including wet hands and direct contact with liquids.
- Do not exert excessive force or use sharp instruments to press the buttons on the lock.
- Ensure that the door is properly locked when going outside.
- Ensure the batteries have been installed according to the correct polarity.
- When the battery life expiration warning sounds, replace all batteries with new batteries within one week.
- Do not mix old batteries with new batteries.
- Do not hang on the lock or pull it with excessive force.
- Use a soft, dry cloth to clean the lock and avoid cleaning with water, benzene or alcohol, etc.

INTRODUCTION

Congratulations on the purchase of your Stand-alone Touchscreen Access Deadbolt!
Your lock combines a touch-sensitive number display pad and a Bored Auxiliary Dead Lock.
You can program up to 50 users to open the lock with unique PIN codes.
This product is engineered for quick & easy installation and fits in place of a standard bored locks door prep. (ANSI/BHMA A156.115).
This product is operated by four (4) "AA" alkaline batteries.

PARTS BREAKDOWN (Continued)

ITEM NO.	DESCRIPTION	QTY.
1	Adjustable backset deadbolt (factory preset 2-3/4"(70mm) backset)	1
2	Touchscreen Escutcheon Assembly	1
3	Interior Escutcheon Assembly	1
4	Battery Cover	1
5	Mounting Plate	1
6	Key (Provided with Cylinder)	2
7	Anti-pry shield	1
8	Strike	1
9	Strike box	1
10	Screw Pack <ul style="list-style-type: none"> ▪ (4) 8-32×3/4"(19mm) FL HD Combination Screws for Latch & Strike ▪ (2) 1/4"×28×2-2/7"(58mm) Machine Screws for Mounting Plate ▪ (2) M4.0×P0.7-15/32"(12mm) Machine Screws for Interior Escutcheon 	1
11	AA Alkaline Batteries	4
12	Battery Cover Screw	1
13	Outside Gasket	1
14	RF Card	2
15	Key Module(optional)	1

TOOLS FOR INSTALLATION

Door Prep.

- Pencil
- Center punch
- Chisel & Hammer
- Drill with 3/8" or 1/2" chuck
- 2-1/8"(54mm) hole saw
- 1"(25mm) boring bit
- 7/64"(2.5mm) drill bit

Lock Installation

- #2 phillips screwdriver

Door Preparation

Mark Door

5. Check lock for proper backset before marking.
6. Fold template over door edge.
7. Mark centers for 2-1/8"(54mm) hole.
8. Mark center for 1"(25mm) diameter latch hole in door edge.

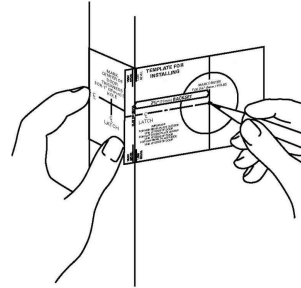

Drill Door

1. Drill 2-1/8"(54mm) diameter hole through the door.
Note: To avoid splintering wood doors, drill holes from both sides of the door.
2. Drill 1"(25mm) diameter hole in edge of door. Mortise for latch front 1"(25mm) wide × 2-1/4"(57mm) high by 5/32"(4mm) deep.
3. Drill pilot holes for the screws used to install the latch. 7/64"(2.5mm)

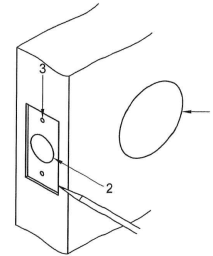

Prepare Door Frame for strike (Wood frames only)

1. Mark vertical line and centerline on frame exactly opposite center of latch hole.
2. Mark drill point 3/8"(10mm) above and below centerline.
3. Drill two overlapping 7/8"(22mm) dia holes, 3/8"(10mm) above and below centerline to a depth of 1-1/8"(32mm).
4. Mortise a cutout for strike. Use strike as a pattern for mortise. (Strike should fit flush with frame.)
5. Drill pilot holes for the screws used to install the strike. 7/64"(2.5mm)

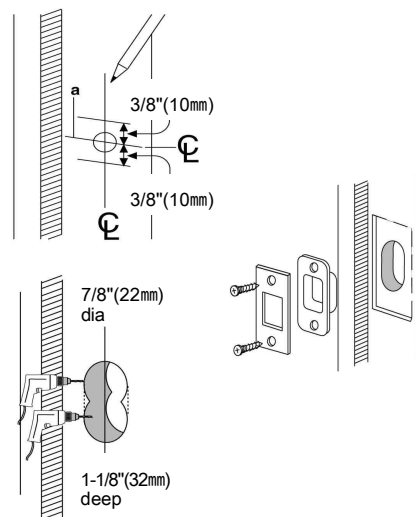

Prepare Lock for Installation

Unpack the Lock

The lock is packed in such a way to represent how it will be installed on the door.

Before installation:

1. Disassemble the Interior Escutcheon.
 - 1) Remove the interior escutcheon.
 - 2) Separate the mounting plate from the interior escutcheon assembly.
2. Remove the battery cover
 - 1) Unscrew the battery cover screw using the #2 phillips screw driver.
 - 2) Take off the battery cover.

The Touchscreen Escutcheon stays assembled.

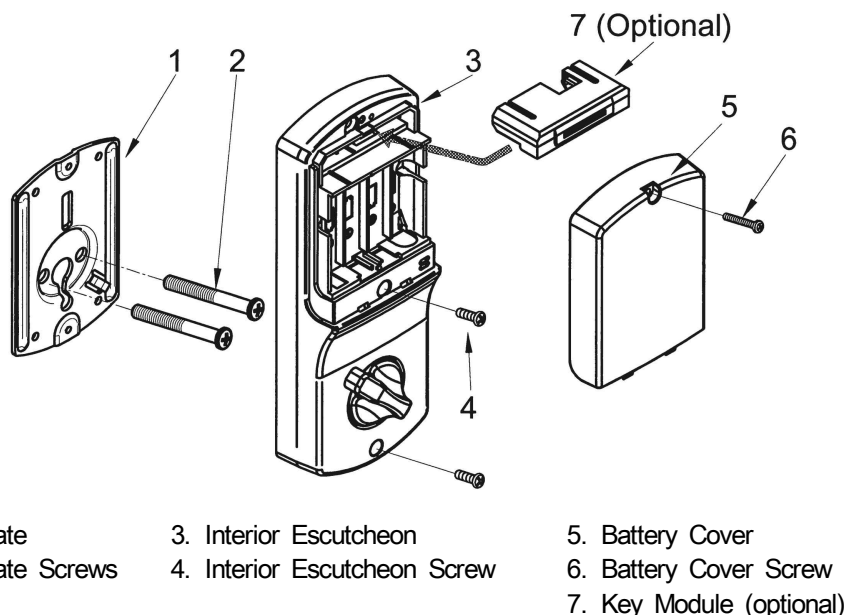

Determine Hand of the Door

Face the door from the secure side to determine it's hand.

The secure side is the touchscreen side of an entrance door or the corridor side of a room door.

Note: Lock is provided for use on RIGHT HANDED door.(factory preset)
If reverse handing is needed, please see PROGRAMMING GUIDE.

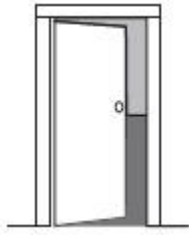

Left Hand
Hinges Left
Open Inward
"LH"

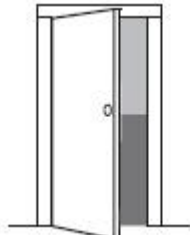

Left Hand Reverse
Bevel Hinges Left
Open Outward
"LHRB"

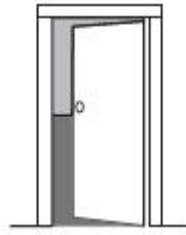

Right Hand
Hinges Right
Open Inward
"RH"

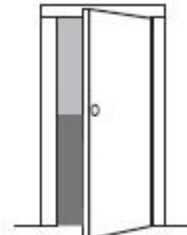

Right Hand Reverse
Bevel Hinges Right
Open Outward
"RHRB"

Adjust bolt length, if necessary.

If the backset of your door is 2-3/4"(70mm), you do not need to do anything. Bolt ships with factory preset 2-3/4"(70mm) backset.

If the backset of your door is 2-3/8"(60mm), you need to adjust your bolt.

A. Bolt must be in a retracted(unlocked) position.

(If necessary, use screwdriver to turn cam and retract bolt.)

B. Press on the bolt with thumb. Rotate faceplate and push down to move housing to next position.

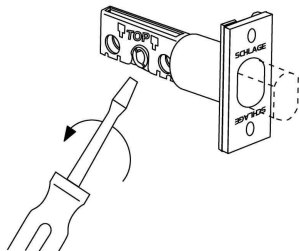

A. Bolt must be retracted

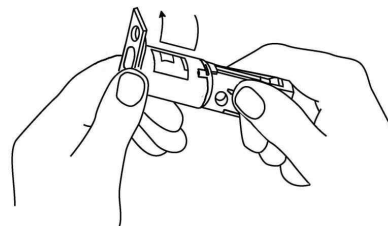

B. Adjust backset

Install Lock

Please follow each step carefully and in order. Because this is an electronic lock, the order of steps is very important. If you skip a step, you may have to start over.

Installation Notes! Please Read!

- DO NOT use a power drill for installation! This could damage the lock.
- DO NOT install the batteries before installing the lock! Follow the instructions in order!
- To replace the old lock with this product on the same door, please confirm the backset for the latch and the specifications for the faceplate match.
- If you have previously installed this lock on another door, you MUST perform a Factory Default Reset FIRST!

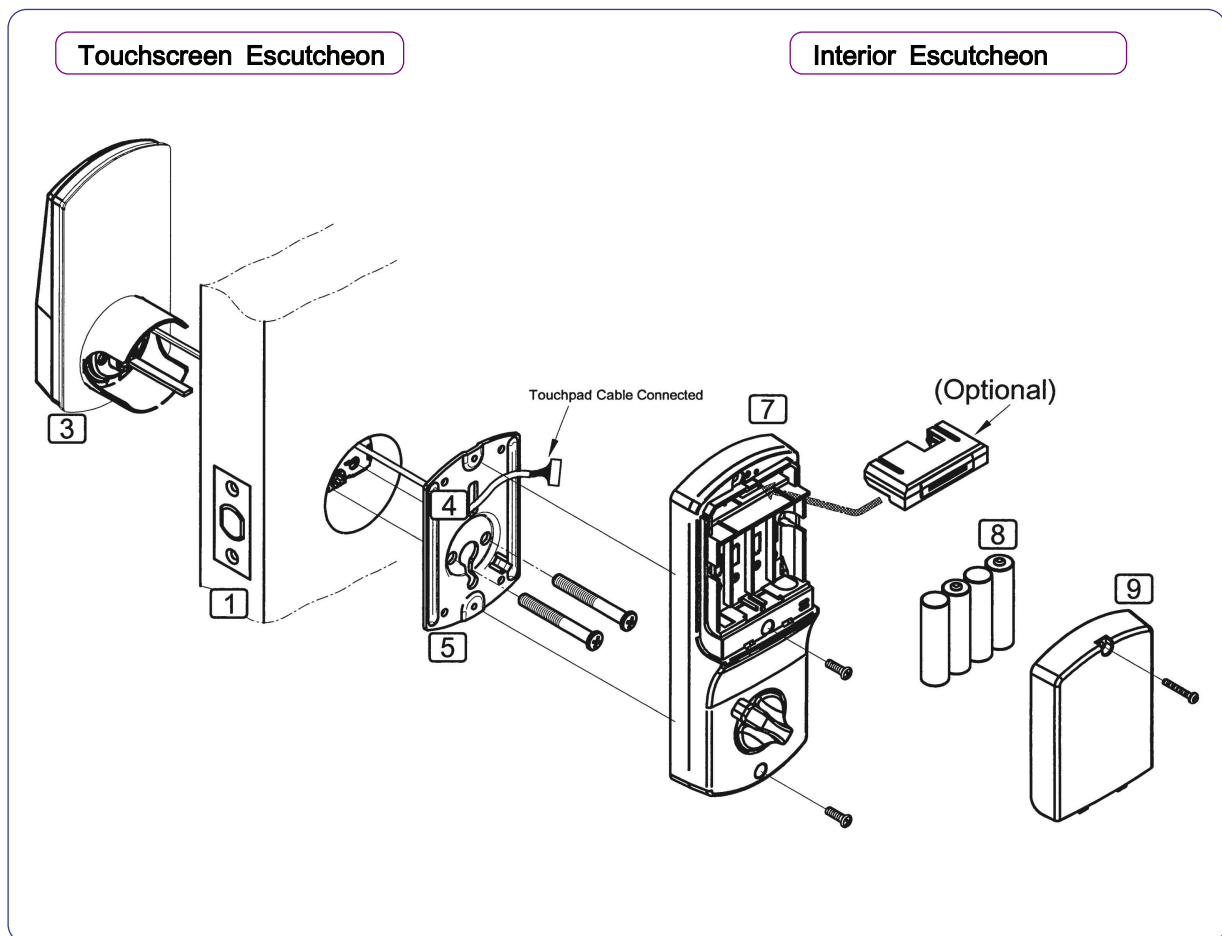

Install Bolt and Strike.

1. Install the Bolt into the door.

Note: The bolt must be in a retracted (unlocked) position when installing the lockset.

Attach with two (2) 8-32×3/4"(19mm) FL HD combination screws supplied.

2. Install the Strike into the door frame.

Note: Make sure to allow for the bolt to be centered in the strike.

Attach with two (2) 8-32×3/4"(19mm) FL HD combination screws supplied.

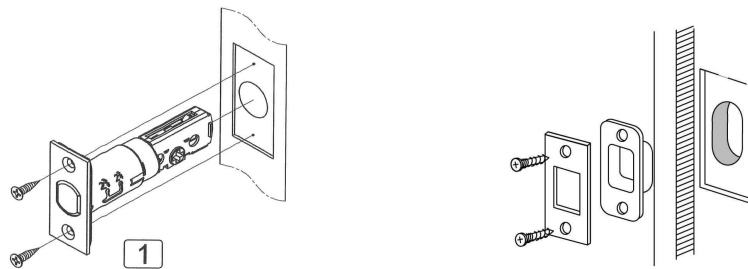

■ TEST BOLT ALIGNMENT.

- 1) Close the door.
- 2) Insert a flathead screwdriver into the slot in the bolt. And then rotate the screwdriver toward the door edge to extend the bolt into the hole in the frame. This operation should be smooth. You should be able to rotate the screwdriver 90°, fully extending the bolt.
- 3) If the operation is not smooth, or if the bolt does not fully extend, adjust your frame and/or door preparation.
- 4) Retract (unlock) the bolt before continuing to next step.

Install the Touchscreen Escutcheon

3. Install the Touchscreen Escutcheon on the outside of the door.

As you position the touchscreen escutcheon, route the cable through 2-1/8"(54mm) diameter hole.

Note: Cable must go **under** the bolt and through. **Ensure that the tailpiece is oriented correctly.** (See Fig. 3)

4. Install the Mounting Plate on the inside of the door.

Holding the touchscreen escutcheon flush to the door, position the mounting plate by the first routing cable and connector through the mounting plate's hole. (See Fig. 4)

Make sure the touchscreen escutcheon and mounting plate are straight on the door before tightening the screws. Tighten screws fully to prevent the lock from moving over time.

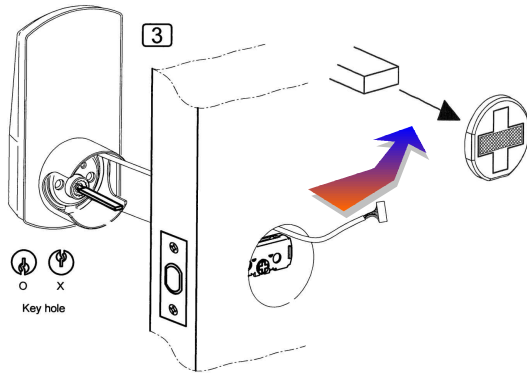

Figure 3

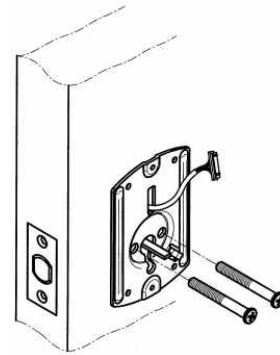

Figure 4

Install the Inside Escutcheon

5. Connect the cable to the Interior Escutcheon.

Attach cable assembly to the interior escutcheon printed circuit board (PCB) by lining up notches on top of cable connector to slots on PCB connector (Fig. 5). Press connector in firmly using thumbs until completely seated (proper position indicated by arrows on PCB as in Fig. 6).

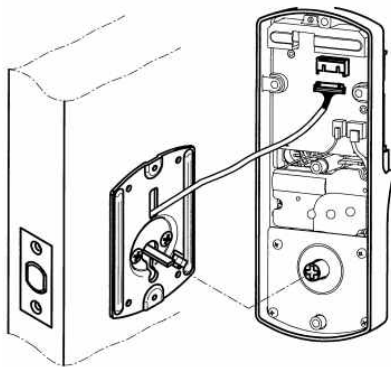

Figure 5

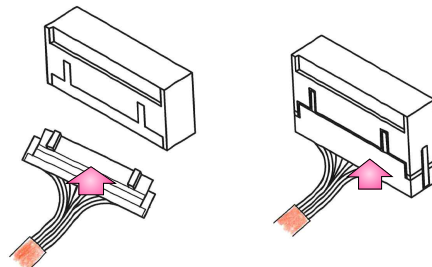

Figure 6

6. Install the Interior Escutcheon on Mounting Plate.

First, check the direction of the thumbturn. (See Fig. 7)

If you have a right-handed door, turn the thumbturn to the left 45°.

If you have a left-handed door, turn the thumbturn to the right 45°. And then, Note in Fig. 8 the horizontal orientation of the tailpiece as you insert the interior escutcheon.

CAUTION: Fold cables and lay against the back recessed area of the interior escutcheon. Position and bend wires to prevent binding when installing the interior escutcheon over the mounting plate.

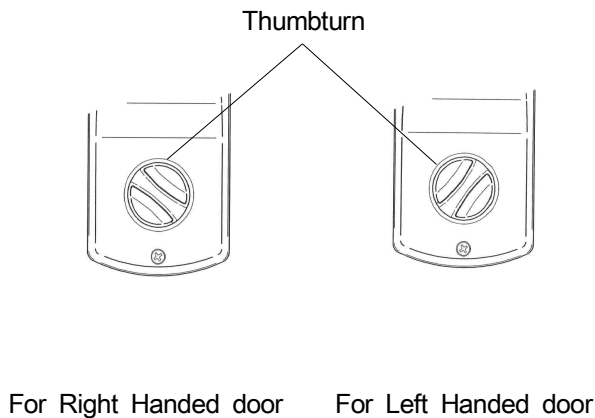

Figure 7

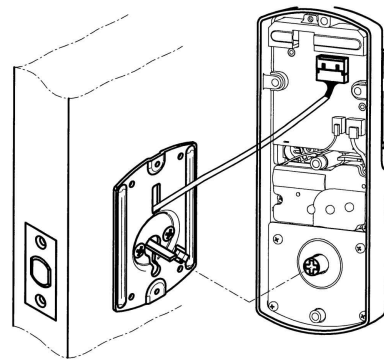

Figure 8

7. Install and secure Interior Escutcheon with the (2) M4×P0.7-15/32"(12mm) screws through interior escutcheon and into the mounting plate assembly.

IMPORTANT:

Before installing the batteries, test the mechanical operation of the lock by using both thumbturn and the key. The movement of the bolt should be smooth and unobstructed. If operation is not smooth, review the previous steps to ensure proper installation.

Install the Batteries

8. Install (4) AA Alkaline Batteries into controller compartment being careful to align +/- polarity properly.

Lock responds, "Ding Dong melody and Number pad blink one time".

9. Install Battery Cover and tighten screw.

Installation Option

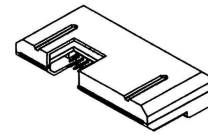

Adding the Key Module to your lock(optional)

1. Install the Key Module into the slot above the battery compartment

⚠ IMPORTANT: The batteries must be removed prior to removing and/or inserting the Key Module:

- Remove battery cover & Remove batteries
- Insert or remove Key Module
- Reinstall batteries & Reinstall battery cover

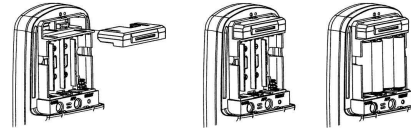

2. Open the app on your smartphone.
3. Follow the app programming instructions for enrolling a new device.

Test the Lock

If you encounter problems while performing any of the following tests, review the installation instructions and this guide and correct any problems.

■ MECHANICAL TEST

1. **Extend/Retract the bolt using the inside thumbturn.**

- 1) Close the door.
- 2) Rotate the thumbturn toward/backward the door jamb to extend/retract the bolt.
- 3) Operation should be smooth.

2. **Extend/Retract the bolt using the key.**

- 1) Close the door.
- 2) Rotate the key toward/backward the door jamb to extend/retract the bolt.
- 3) Operation should be smooth.

■ ELECTRONIC TEST

Caution: Keep the key with you during testing to avoid being locked out!

1. **Extend the bolt (lock) using the Touchscreen.**

- 1) Unlock the door using the thumbturn if you have not already.
- 2) Touch touchscreen of lock with back of hand or fingers.
- 3) The bolt should extend.

2. **Retract the bolt (unlock) using the Touchscreen.**

- 1) Touch touchscreen of lock with back of hand or fingers.
- 2) Enter factory defaults Master Code [123456] and press the [*] button.
- 3) The bolt should retract.

3. **If the lock fails to lock or unlock:**

- 1) If the touchscreen does not light up, you may have a power problem. Install fresh batteries and make sure the battery connector is connected. If that does not help, make sure the cable is connected to the interior escutcheon and is not crimped.
- 2) Even if lock has power, you may need to check and adjust your door/frame.

PROGRAMMING GUIDE

Take the time to read through this guide to familiarize yourself with the features and operation of the lock, and its quick and easy programming procedures.

TABLE OF CONTENTS

Overview	13
Operation of Lock	14~15
Programming Features	16~18
Programming	19~23
Miscellaneous Information	24
Definitions	25
Troubleshooting	26
User Code Record Sheet	27

OVERVIEW

Stand-Alone Access Control System is a series of State-of-the-Art Microprocessor-Based programmable Touchscreen-Entry Security Locks.

- User Access Methods
 - ☞ Touchscreen Entered User PIN Codes.
 - ☞ RF Card
 - ☞ Metal Key cylinder
 - ☞ Mobile App(Optional)
- User Features
 - ☞ 500 users.
 - ☞ User code length from 4-6 digits.
- Preparing to Program your Lock
 - ☞ At first glance, your new lock may look complicated, but it is in fact designed in a very straightforward way. The keypad contains 12 buttons: numbers 1 through 9 plus zero, a star button [*] and a pound button [#].
 - ☞ These 12 buttons are all you need to program your lock.
 - ☞ All features can be programmed manually through the touchpad.
 - ☞ This guide will show you how to program your lock manually.
- The lock can be programmed for Lockout mode settings. Door Hanging or Auto re-lock time and Beep sound are adjustable and can be changed from factory default.

OPERATION OF LOCK

Opening the door with a PIN Code

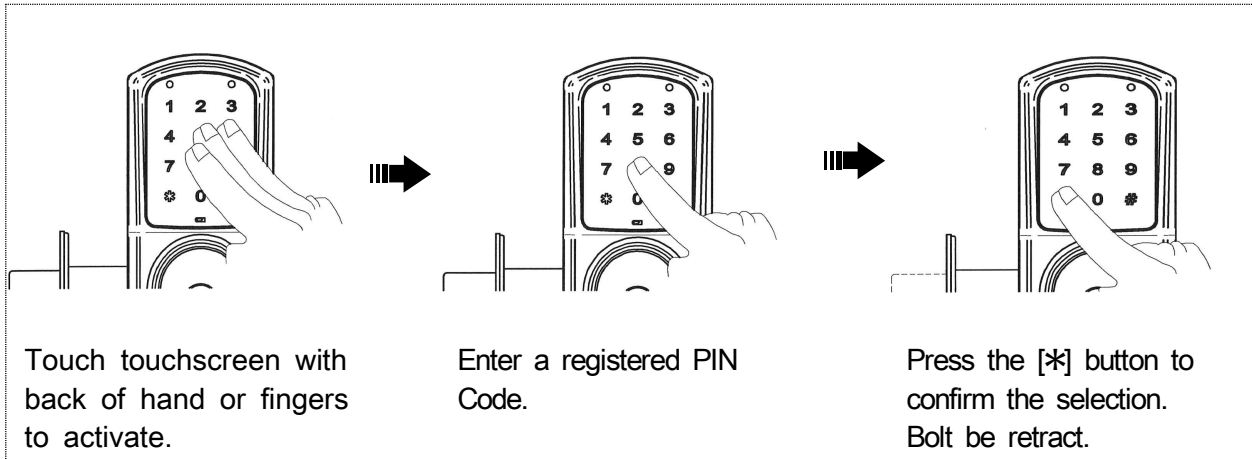

Opening the door with a RF Card

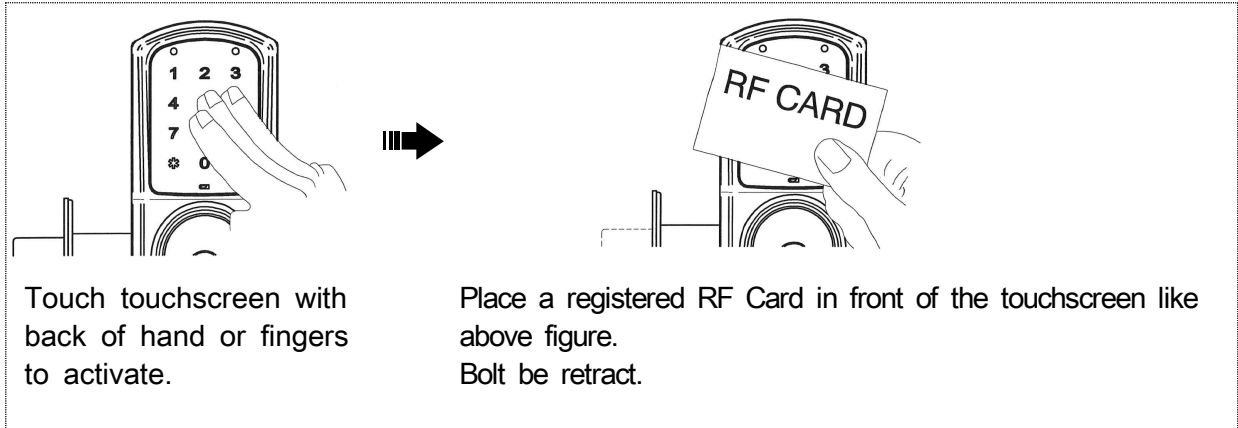

Opening the door with a Metal Key

- A. Insert the key into keyway.
- B. Rotate the key to retract bolt.

Factory Defaults

Settings	Factory Defaults
Master PIN Code	123456
Lockout Mode	Unprogrammed
Passage Mode	Unprogrammed
Re-lock Time	5 seconds
Wrong Code Entry Limit	5 times
Shut Down Time	60 seconds
Beep Volume	2 levels
Door Handing Setting	"RH" (Right Hand)

Scope of Master, User Settings

Settings	Master	User
Entrance Authorization	√	√
Register/Change Master PIN Code	√	
Register/Delete User PIN Code	√	
Register/Delete RF Card	√	
Registering One-time User PIN Code	√	
Setting Up/Releasing User Lockout Mode	√	
Entrance Authorization at Lockout Mode	√	
Setting Up/Releasing Passage Mode	√	
Setting Up the Sound Volume	√	

PROGRAMMING FEATURES

Touchscreen Escutcheon

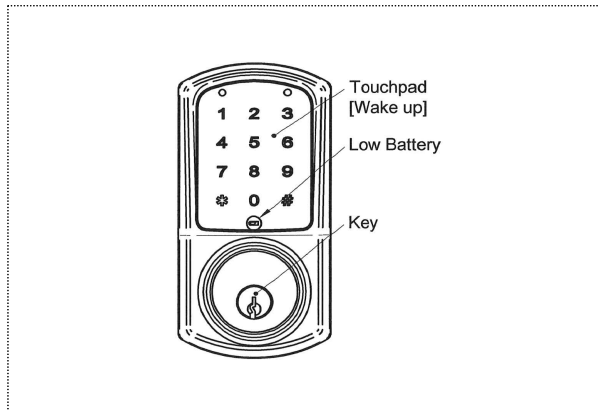

Interior Escutcheon

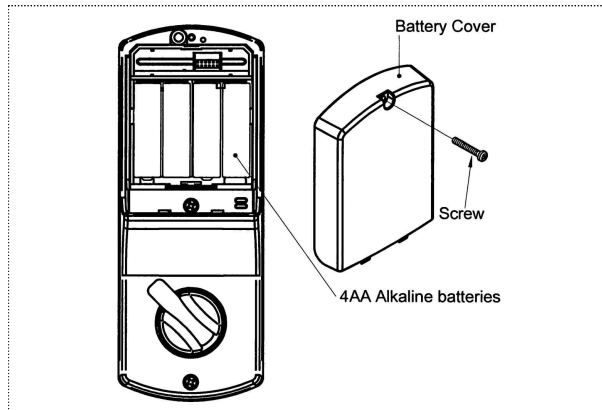

Menu and Icons

Symbols	Description
	Touch the screen with back of hand or fingers to activate.
	Press the indicated number buttons.
	Press the Star[*] button. It is used to complete an input process.
	Press the Pound[#] button. It is used to enter Programming mode.
	Enter the Master PIN Code (Must be 6 digits in length). [Factory Default: 123456]
	Enter the User PIN Code (4~6 digits in length).
	Low Battery Icon. When battery power is low, the low battery icon will begin blinking.

Door Handing Identification

Note: Run the door handing identification process before setting up other functions.

Lock is provided for use on RIGHT HANDED door.(factory preset)

If reverse of door handing is needed, please see the steps below.

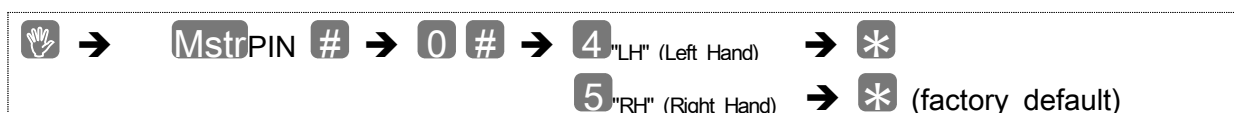

To Begin Programming:

The lock is preset at the factory with Master PIN Code [123456].

- A.  Touch touchscreen of lock with back of hand or fingers to activate. The bolt will extend (lock).
- B. Enter the factory default Master PIN Code **1 2 3 4 5 6** and ***** button into the lock. The bolt will retract (unlock).

Note: The Master PIN Code must be changed (i.e., "Forced Change") from the factory default prior to any other programming of the lock.

Feature Programming Through Master Code

Procedure Description

-  Touch screen with back of hand or fingers to activate.
- Step 1. Enter the Master PIN Code and press the **#** button.
- Step 2. Enter Program Code and press the **#** button.
- Step 3. Enter digit corresponding to the function to be performed and press the **#** button.
- Step 4. Press the **#** button to confirm.
- Step 5. Press the ***** button to complete the process and conclude the Programming session.

Change Default Master PIN Code Before Programming



Register User PIN Code



Delete registered PIN Code except Master PIN Code



Register One-Time User PIN Code

 → MstrPIN # → 4 # → Enter One-Time U PIN # → # → *

Setting Up/Releasing Lockout Mode

 → MstrPIN # → 7 # → 1 Enable *

→ 3 Disable *

Setting Up the Beep Sound or Auto Re-lock or Door Handing

 → MstrPIN # → 0 # → 1 Volume # → 1 ~ 4 *

2 Re-lock Time # → 0 Disable *

1 10 sec ~ 9 90 sec *

4 "LH" left Hand → *

5 "RH" Right Hand → *

- ☞ Sound Volume: 1 minimum volume ~ 3 maximum volume, 4 mute.
- ☞ Re-lock Time: 2 Re-lock Time # and 0 to 9 settings. (factory default 0 setting)
- ☞ Door Handing: 4 "LH" left Hand, 5 "RH" Right Hand settings. (factory default 5 setting)

Register RF Card

 → MstrPIN # → 8 # → Enter the Card Register No. (0~499) # → Place the RF Card on Touchscreen # → *

Delete RF Card

 → MstrPIN # → 9 # → Enter the Card Register No. (0~499) # → # → *

PROGRAMMING

Change Default Master Code Before Programming

Note: The factory default Master Code must be changed prior to any other programming of the lock.

 → Default Mstr PIN # → 1 # → Enter New Mstr PIN # → Enter New Mstr PIN # → *

 Touch screen with back of hand or fingers to activate.

1. Enter the default Master PIN Code **1 2 3 4 5 6** and press the **#** button.
Green and Red LED blinks.
2. Enter the Program Code **1** and press the **#** button.
Green and Red LED blinks.
3. Enter the new Master PIN Code and press the **#** button.
Beep melody with Green LED blinks.
4. Enter the new Master PIN Code again and press the **#** button.
Beep melody and Number pad blink one time.
5. Press the ***** button.
Completes with beep sound.

[For example, if you want your new Master PIN Code to be "258013". Press:

 → 1 2 3 4 5 6 # → 1 # → 2 5 8 0 1 3 # → 2 5 8 0 1 3 # → *

Now that the Master Code has been changed, there is no need to change it again (unless you want to).

Register User PIN Code

 → Mstr PIN # → 2 # → Enter U PIN # → # → *

 Touch screen with back of hand or fingers to activate.

1. Enter the Master PIN Code and press the **#** button.
Green and Red LED blinks.
2. Enter the Program Code **2** and press the **#** button.
Green and Red LED blinks.
3. Enter the new User PIN Code and press the **#** button.
Beep melody with Green LED blinks.

4. Press the  button.

Beep melody and Number pad blink one time.

☞ [Repeat steps 3 and 4 for each new user (if necessary).]

5. Press the  button.

Completes with beep sound.







[For example, John Smith and Jessica are users. You want to register their User PIN Codes "111222" and "223344".

Program the lock by pressing:  → MstrPIN  → 2  → 1 1 1 2 2 2  → #
→ 2 2 3 3 4 4  → # → *]

Delete registered PIN Code except Master PIN Code

 → MstrPIN  → 3  → Registered U PIN  → # → *

 Touch screen with back of hand or fingers to activate.

1. Enter the Master PIN Code and press the  button.
Green and Red LED blinks.
2. Enter the Program Code  and press the  button.
Green and Red LED blinks.
3. Enter the registered PIN Code and press the  button.
Beep melody with Green LED blinks.
4. Press the  button.
Beep melody and Number pad blink one time.
☞ [Repeat step 3 and 4 for deletion of another registered PIN Code (if necessary).]
5. Press the  button again.
Completes with beep sound.

[For example, You want to delete registered PIN Codes "111222" and "223344".

Program the lock by pressing:  → MstrPIN  → 3  → 1 1 1 2 2 2  → #
→ 2 2 3 3 4 4  → # → *]

Register One-Time User PIN Code

 → MstrPIN  → 4  → One-Time U PIN  → # → *

 Touch screen with back of hand or fingers to activate.

1. Enter the Master PIN Code and press the **#** button.
Green and Red LED blinks.
2. Enter the Program Code **4** and press the **#** button.
Green and Red LED blinks.
3. Enter the One-Time User PIN Code and press the **#** button.
Beep melody with Green LED blinks.
4. Press the **#** button.
Beep melody and Number pad blink one time.
☞ [Repeat steps 3 and 4 for each new one-time user (if necessary).]
☞ You may register up to 2 One-Time User PIN Codes.
5. Press the ***** button.
Completes with beep sound.

Setting Up/Releasing Lockout Mode

☞ → MstrPIN **#** → **7** **#** → **1** Enable *****
→ **3** Disable *****

- ☞ Touch screen with back of hand or fingers to activate.
1. Enter the Master PIN Code and press the **#** button.
Green and Red LED blinks.
 2. Enter the Program Code **7** and press the **#** button.
Green and Red LED blinks.
 3. Enter the Enable Code **1** or Disable Code **3** and press the ***** button.
Completes with beep sound.

Register RF Card

☞ → MstrPIN **#** → **8** **#** → Enter the Card Register No. (0~499) **#** → Place the Card in front of the Touchpad **#** → *****

- ☞ Touch screen with back of hand or fingers to activate.
1. Enter the Master PIN Code and press the **#** button.
Green and Red LED blinks.
 2. Enter the Program Code **8** and press the **#** button.
Green and Red LED blinks.
 3. Enter the new RF Card Register Number(0~499) and press the **#** button.
Green and Red LED blinks.
 4. Place a RF Card about 2 seconds in front of the touchscreen (hear beep melody and

Green LED blinks.) and press the **#** button.

Beep melody and Number pad blink one time.

☞ [Repeat step 3 and 4 for each new RF Card Register (if necessary)].

5. Press the ***** button.

Completes with beep sound.

[For example, you wish to register two RF Cards for User 11 and User 12 respectively.

Press: → **Mstr**PIN **#** → **8** **#** → **1 1** **#** → place the first card in front of the touchscreen (hear beep melody and Number pad blink one time) **#** and then within 20 seconds, **1 2** **#** → place the second card in front of the touchscreen (hear beep melody and Number pad blink one time) **#** → *****]

Delete RF Card

→ **Mstr**PIN **#** → **9** **#** → Enter the Card Registered No. (0~499) **#** → **#** → *****

Touch screen with back of hand or fingers to activate.

1. Enter the Master PIN Code and press the **#** button.

Green and Red LED blinks.

2. Enter the Program Code **9** and press the **#** button.

Green and Red LED blinks.

3. Enter the card number you want to delete (registered number) and press the **#** button.

Beep melody and Green LED blinks.

4. Press the **#** button.

Beep melody and Number pad blink one time.

☞ [Repeat steps 3 and 4 for deletion of another card number(if necessary)].

5. Press the ***** button.

Completes with beep sound.

[For example, you wish to delete two RF Cards for User 11 and User 12 respectively.

Press: → **Mstr**PIN **#** → **9** **#** → **1 1** **#** → **#** → **1 2** **#** → **#** → *****]

Setting Up the Beep Sound or Auto Re-lock or Door Handing

 → MstrPIN # → 0 # → 1 Volume # → 1~4 *
 2 Re-lock Time # → 0 Disable *
 1 10 sec ~ 9 90 sec *
 4 "LH" left Hand → *
 5 "RH" Right Hand → *

☞ **Sound Volume:** 1 minimum volume ~ 3 maximum volume, 4 mute.
 ☞ **Re-lock Time:** 2 Re-lock Time # and 0 10 sec to 9 90 sec settings. (factory default 0 setting)
 ☞ **Door Handing:** 4 "LH" left Hand, 5 "RH" Right Hand settings. (factory default 5 setting)

 Touch screen with back of hand or fingers to activate.

1. Enter the Master PIN Code and press the # button.
Green and Red LED blinks.
2. Enter the Program Code 0 and press the # button.
Green and Red LED blinks.
3. **Setting Up the Beep Sound:** Enter the Sound Volume 1 minimum volume ~ 3 maximum volume, 4 mute and press the * button. Completes with beep sound.

Setting Up the Auto Re-lock: Enter the Re-lock Time Code 2 and press the # button and press function key 0~9 and press the * button. Completes with beep sound.

Setting Up the Door Handing: Enter the LH (left hand) Code 4 or RH (right hand) Code 5 and press the * button. Completes with beep sound.

MISCELLANEOUS INFORMATION

Returning the Lock to Factory Defaults

1. Remove the battery cover and batteries.
2. After 10 seconds reinsert the batteries.
3.  Touch touchscreen with back of hand or fingers to activate within 5 seconds.
4. Enter the [#] button 5 times and factory defaults Master Code [123456] [#] and 30 [#] and press the 1 [*] button.
→ 1 2 3 4 5 6 # → 3 0 # → 1 *
5. A little later, the number pad is turned off and reset is complete.

Note:

All registered Master and User PIN Code data, etc., will be deleted, and the lock will reset to the factory default.

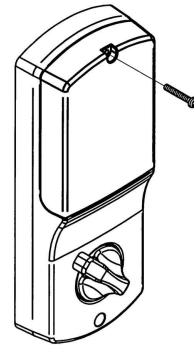

Battery Replacement

When battery power is low, the low battery icon will begin blinking with beep sound. Always replace weak batteries as soon as possible. The locks use four (4) AA-size 1.5 volt alkaline batteries.

DEFINITIONS

Wake Up: Touch the screen with back of hand or fingers to activate. Enter the PIN Code while the number pad is illuminated.

Master PIN Code: The Master PIN Code is used for programming User codes and feature settings. The Master PIN Code will operate the lock. The Master PIN Code is a factory default setting.

User PIN Code: The User PIN code is used for operating the lock.

One-Time User PIN Code: This PIN Code can only be used once and the PIN information is deleted automatically after use. User can program in up to 2 different One-Time User PIN Codes.

Lockout Mode: This feature is enabled by the Master PIN Codes. When enabled, it restricts all User PIN Code access except Master PIN Codes.

Low Battery: When battery power is low, the low battery icon will begin blinking. If battery power is completely lost, the key cylinder can be used.

Auto Re-lock Time: When enabled, After successful code entry and the unit unlocks, it will automatically re-lock after 10~90 seconds. (Disabled by default.)

Beep Sound: The Beep Sound can be turned on/off if desired.

Shut Down Time: The unit will shut down for a default of sixty (60) seconds and not allow operation after the wrong code entry limit has been met. Shut down time is factory default settings.

Wrong Code Entry Limit: After a default of five (5) unsuccessful attempts at entering a valid PIN Code the unit will shut down and not allow operation. Wrong code entry limit is a factory default setting.

TROUBLESHOOTING

Symptom	Suggested Action
There is no power.	<ul style="list-style-type: none"> • Check if the batteries are faulty or in the correct polarity. • Check if the batteries are inserted properly or completely discharged.
I can't change the Master PIN Code.	<ul style="list-style-type: none"> • There was a delay while entering the new Master PIN Code. The number pad must be illuminated while the new Master PIN Code is being entered. Also, after entering the first digit the next digit must be entered within 10 seconds. • If batteries are discharged, try again after replacing the batteries. • Refer to the changing the Master PIN Code section in the programming instructions and try changing again.
I can't change the User PIN Code.	<ul style="list-style-type: none"> • Another PIN Code is already registered. • If the PIN Code is less than 4 digits or over 6 digits in length, change it to be within 4~6 digits and register again.
I entered registered PIN Code and pressed the [*] button, but the door won't open.	<ul style="list-style-type: none"> • Check that the registered PIN Code was entered correctly. • If the number pad illumination is turned off while entering the PIN Code, the button input is not registered. Touch screen with back of hand or fingers to activate and enter PIN Code again. (The number pad illumination is turned off automatically if there is no input within 10 seconds.)
The lock issues the low voltage warning sound when I activate the lock.	<ul style="list-style-type: none"> • The sound indicates that it is time to replace the batteries. Replace with new batteries within a week.
Unit operates to allow access, but will not automatically re-lock	<ul style="list-style-type: none"> • If low battery indicator is lit, replace batteries.
Lock does not respond – door is locked and inaccessible.	<ul style="list-style-type: none"> • Batteries may be completely discharged. • Use mechanical key to gain entry and replace batteries.
The unit is on for a while, and then shows no reaction. Lights dim.	<ul style="list-style-type: none"> • The batteries do not have enough power. Replace the batteries.

[illegible]

DWG # ELG8056-08/25-27 of 27