

MAGNETIC DOOR HOLDER

Features

- Tri-voltage (Can be wired 12V DC, 24V AC / DC or 120V AC)
- Can be used on Fire or Smoke Barrier doors Held-Open until released by a remote switching device
- Used alternatively as Hold-Open system
- Thru-bolted Armature for Security
- 30-45 Pound Holding Power
- Underwriters US and Canada Listed
- ANSI / BHMA A156.15
- Available in US28 (Brushed Aluminum), Duro and Gold finishes



MDHR-1 RECESSED WALL MOUNT

PACKED WITH 1" EXTENSION BOLT

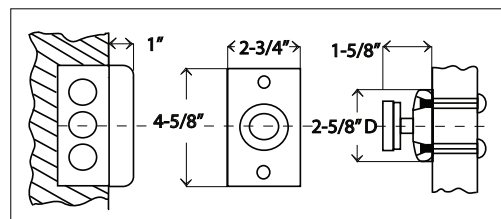

MDHS-2 SURFACE WALL MOUNT

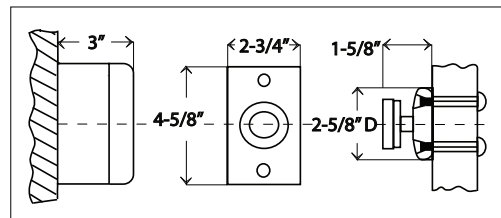
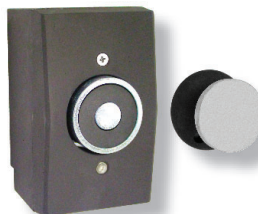

PERFORMANCE DATA			
MODEL	VOLTS	mAmps	VA
MDHR-1	12 DC	60	72
MDHS-2			

ITEM #	DESCRIPTION	FINISH	PCS /MC	UNIT
MDHR-1	Magnetic door holder recessed wall mount with 1" extension bolt	US28 DURO GOLD	1	Ea.
MDHS-2	Magnetic door holder surface wall mount			
MDHEXT-3	Additional 1" Extension Bolt	US28		

CROSS REFERENCE									
FUNCTION	CAL-ROYAL	ABH	DORMA	RIXSON	NORTON	YALE	SARGENT	CORBIN RUSSWIN	LCN
RECESSED WALL MOUNTED 3 3/8" TOTAL PROJECTION	MDHR-1	2100* with 1" extension	EM-F24120	FM-998	6933	5933	1560	MA 204 MA 244	SEM 7850
RECESSED WALL MOUNTED 2 3/8" TOTAL PROJECTION	MDHR-1	2100	EM-F24120	FM-997	6934	5934	1560	MA 203 MA 243	SEM 7840
SURFACE WALL MOUNTED 4 3/8" TOTAL PROJECTION	MDHS-2	2300	EM-S24120	FM-996 FM-999	6935	5935	-	-	SEM 7830