

## FULL MORTISE PLAIN BEARING HINGE

For standard weight doors receiving low frequency service. Designed to have both leaves mortised into the door and the jamb. The hinge sits flush with the surface of the door and frame when installed, leaving a smooth finished appearance.

### AVAILABLE FINISHES:

USP, USPNRP, US26D, US26DNRP, US10, US10A, US10B, US15, US15A, US4, US3, US5, US26, US32D, US32DNRP, DURO

### MATERIAL:

Steel, Stainless Steel, Brass

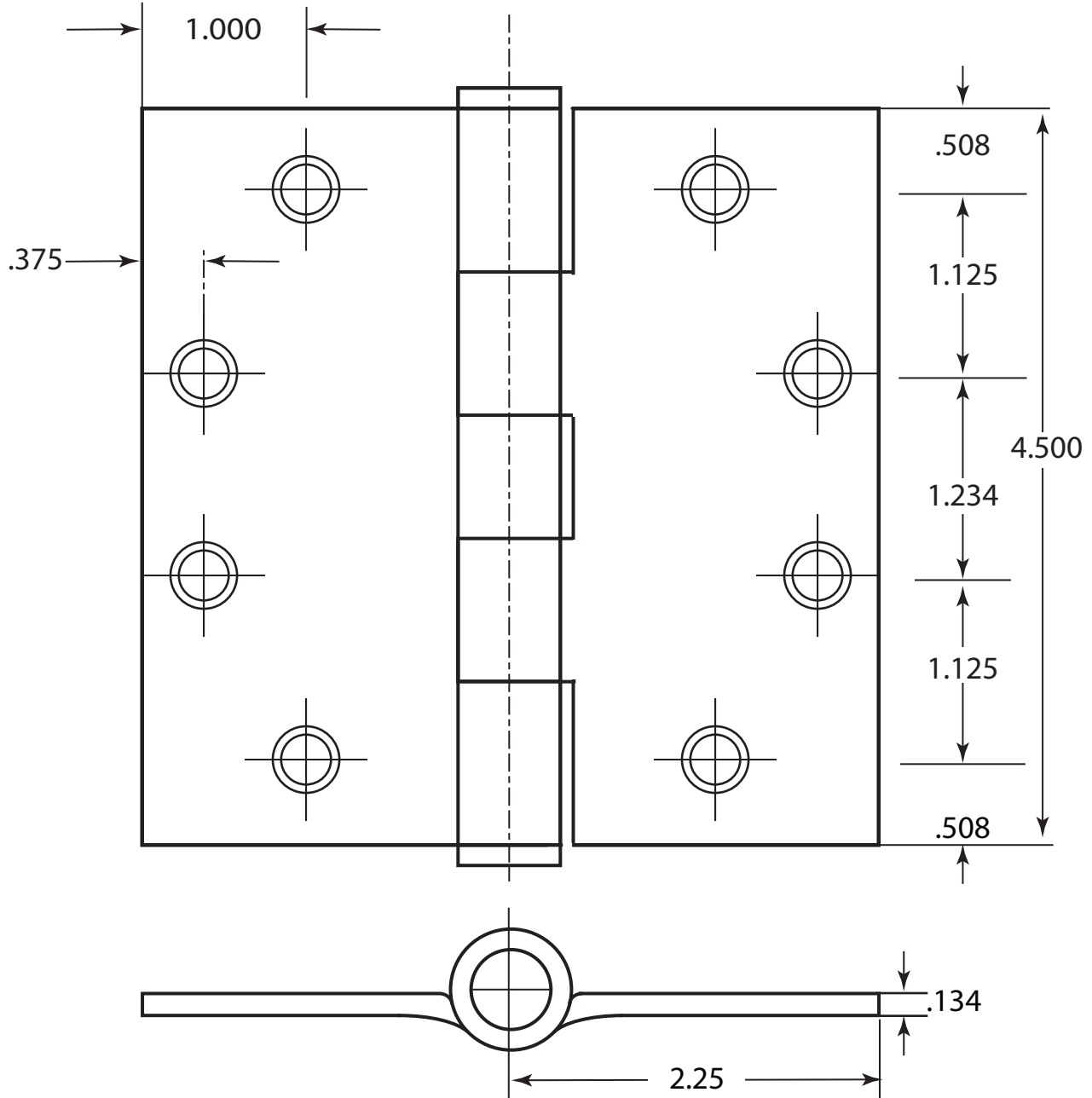

Size of FH Screws		Pieces Per Box	Pieces Per Carton
Machine	Wood	3	48
1/2" x 12 - 24	1 1/4" x 12		



6605 Flotilla St.  
City of Commerce  
CA 90040 USA  
Tel: (323) 888-6601  
FAX: (323) 888-6699  
Website: cal-royal.com  
Email: sales@cal-royal.com

ITEM NO.:	DESCRIPTION:	SCALE:
<b>TBH-30</b>	STANDARD WEIGHT HINGE FULL MORTISE TEMPLATE 4-1/2" X 4-1/2" SQUARE CORNER	1:1
ANSI:	UNIT:	VERSION:
A156.1	inches (mm)	ver. 1.0 rev. 01/12
		BY:
		bteves/jsa